

# Slope front

ice storage bins



Model E-650-44 shown

---

## Features

Capacities available from 137 - 454 kg (300 - 1000 lb) and widths from 55.9 cm to 132.1 cm (22.00" to 52.00")

### Convenient design

- extra large door openings for maximum access
- low sill height allows access to reach bottom of bin
- 55.9 cm (22.00") and 76.2 cm (30.00") bins match with compact ice machines to maximize ice production and storage in small space
- model E-600-42 is 68.6 cm (27.00") deep and will fit through 71.1 cm (28.00") door

### Durable construction

- full stainless top, front and sides standard
- heavy-duty welded steel shell and frame support
- poly-lined interior to eliminate corrosion
- rigid, insulated stainless steel lift door with non-staining ABS interior
- fully replaceable gasket seals door opening

### Easy installation

- comes assembled, simply screw in legs
- all models will fit through 81.3 cm (32.00") doors (for 58.4 cm (23.00") doors order model E-300-22) or for 71.1 cm (28.00") doors order model E-600-42)

---

## Accessories

- 15.24 cm (6.00") stainless steel legs (item# ABSPECLEGS)
- 20.32 cm (8.00") legs (standard on E-300-22) (item# 00161547)
- Center partition (E-650-44, E-950-48 and E-1025-52 only)
- Additional carts and accessories (refer to form# 3435)

Job

Item

Follett Europe Polska Sp. z o.o.  
Mokry Dwór 26C 83-021 Wiślina, Poland  
+48 (58) 785-6140 | Fax: +48 (58) 785-6159  
folletteurope.com

801 Church Lane | Easton, PA 18040, USA  
1.610.252.7301 | Fax: +1.610.250.0696 | follettice.com

**FOLLETT**<sup>®</sup>

## Specification

Maximum bin capacity	see model table below
<b>W1</b> Width	see model table below
<b>D1</b> Depth at bottom	see model table below
<b>D2</b> Depth at door	80.0 cm (31.50")
<b>D3</b> Depth with door fully extended	105.4 cm (41.50")
<b>H1</b> Height (adjustable)	see model table below
<b>H2</b> Bin sill height	see model table below
Required door access	see model table below
<b>L1</b> Drain <sup>1</sup>	1.00" FPT, center of bin bottom
Ice compatibility	all ice types
Shipping weight	see model table below

NOTE: For indoor use only

SHORT FORM SPECIFICATION: Ice storage bin to be Follett model \_\_\_\_\_. Bin to hold approximately \_\_\_\_\_ kg (lb) of ice. Construction to be welded steel shell and frame. Exterior finish to be stainless steel front and sides with galvanized steel back and bottom. Bin interior to have non-corroding polyethylene-lined walls and stainless steel bottom. Bin insulation to be non-CFC polyurethane foam, bonded to shell and polyethylene-lined walls for added structural strength. Bin top to be stainless steel and to be custom-cut for specific ice machine(s) to be used. Lift door to have stainless steel exterior and ABS interior, bonded together with non-CFC polyurethane foam for extra rigidity and strength. Bin to have conveniently low door sill height to allow easy access to ice in the bottom of the bin. Door opening to be completely sealed with fully replaceable gasketing. Bin to have 15.24 cm (6.00") legs, adjustable to 17.14 cm (6.75") (model E-300-22 has 20.32 cm (8.00") legs). Bin drain to be 1.00" FPT rigid PVC. NSF listed.

## Dimensional drawing

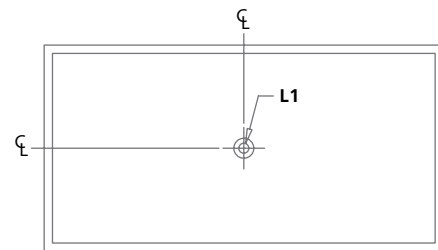
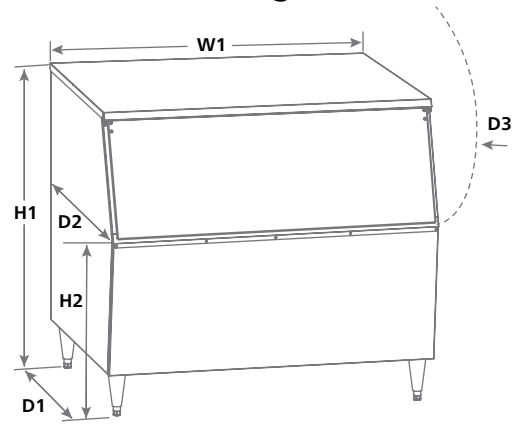

MAESTRO PLUS is a trademark of Follett LLC.  
FOLLETT is a registered trademark of Follett LLC, registered in the US.  
Follett reserves the right to change specifications at any time without obligation. Certifications may vary depending on country of origin.

Model	Maximum bin capacity kg (lb)	Cubic volume m (cu ft)	Width - <b>W1</b> cm (in)	Depth - <b>D1</b> cm (in)	Height - <b>H1</b> cm (in)	Door sill height - <b>H2</b> cm (in)	Required door access cm (in)	Approximate ship weight kg (lb)
E-300-22 <sup>2</sup>	136 (300)	0.27 (9.6)	55.9 (22.00)	74.9 (29.50)	101.6 (40.00)	66.0 (26.00)	23.00 (58.4)	58 (128)
E-425-30	195 (430)	0.39 (13.8)	76.2 (30.00)	74.9 (29.50)	101.6 (40.00)	66.0 (26.00)	31.00 (78.7)	74 (163)
E-600-42	258 (567)	0.51 (18.1)	108.7 (42.80)	68.6 (27.00)	101.9 (40.10)	73.9 (29.10)	28.00 (71.1)	70 (154)
E-650-44	299 (660)	0.59 (20.8)	111.8 (44.00)	74.9 (29.50)	101.6 (40.00)	66.0 (26.00)	32.00 (81.2)	80 (176)
E-950-48	431 (950)	0.85 (30.1)	121.9 (48.00)	71.8 (28.25)	127.0 (50.00)	91.4 (36.00)	32.00 (81.2)	96 (212)
E-1025-52	467 (1030)	0.92 (32.6)	132.1 (52.00)	71.8 (28.25)	127.0 (50.00)	91.4 (36.00)	32.00 (81.2)	112 (247)

### Notes:

- <sup>1</sup> Follett recommends installation of a floor drain with grate with all ice storage bins.
- <sup>2</sup> Model 300-22 only for use with Follett<sup>®</sup>, Maestro Plus<sup>™</sup> 425 series ice machines.

## E-Slope front bins

