

# Horizon™ Ice Machine Installation Instructions for Ice Storage Bin Top-mount Applications

HCD/HMD/HCF/HMF1000RBT, HCD/HMD/HCF/HMF1400RBT, HCD/HMD/HCF/HMF1650RBT,  
HCD1000NBT, HMD1000NBT, HCD1400NBT, HMD1400NBT, HCD1650NBT, HMD1650NBT  
(See model number configurator on page 2 for details.)

Order parts online  
[www.follettice.com](http://www.follettice.com)

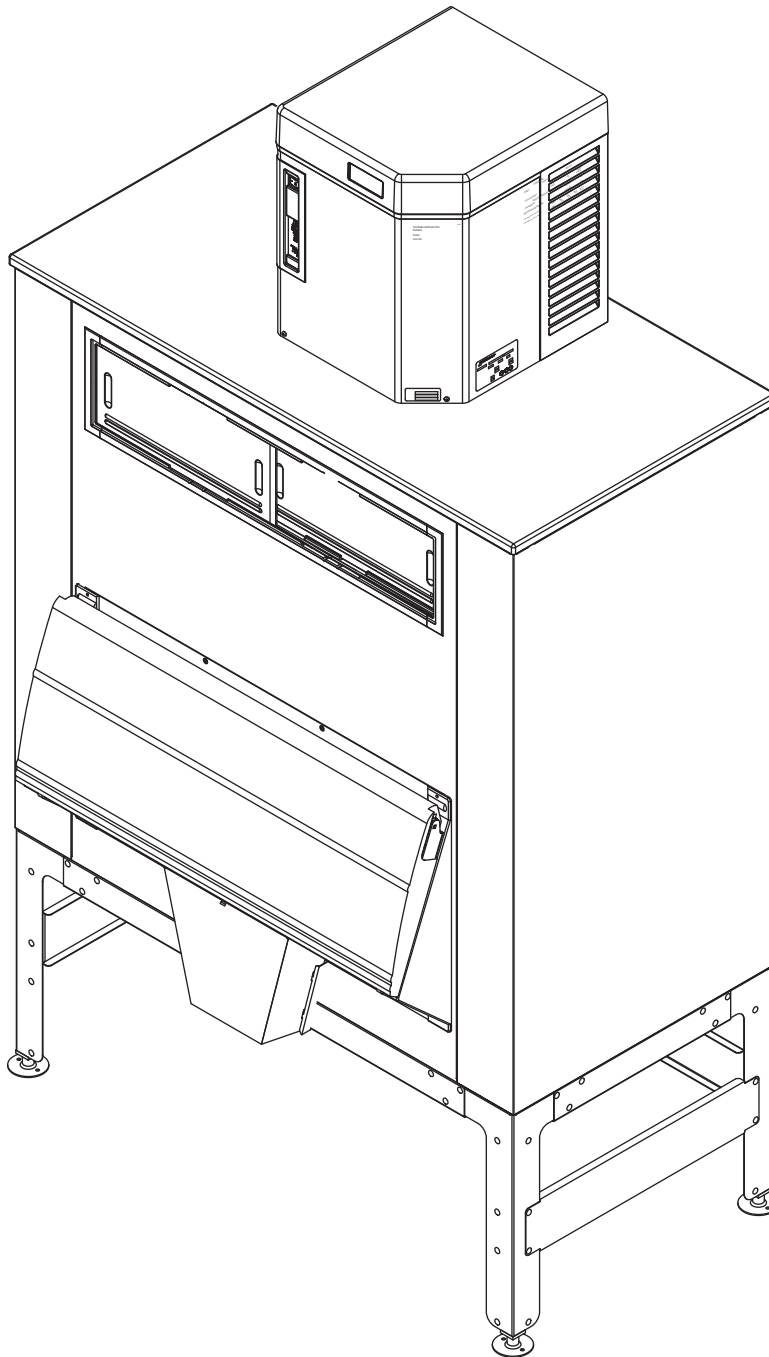
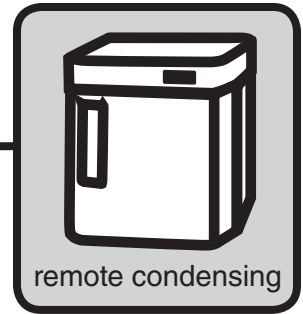

## Chewblet® Ice Machine Model Number Configurations

<div style="display: flex; justify-content: space-around; align-items: center;"> <div style="border: 1px solid black; padding: 2px 5px;">HC</div> <div style="border: 1px solid black; padding: 2px 5px;">C</div> <div style="border: 1px solid black; padding: 2px 5px;">1400</div> <div style="border: 1px solid black; padding: 2px 5px;">A</div> <div style="border: 1px solid black; padding: 2px 5px;">V</div> <div style="border: 1px solid black; padding: 2px 5px;">S</div> </div>					
Icemaker	Voltage	Series	Condenser	Application	Configuration
MC Maestro™ Chewblet® (400 Series)	C 208-230/60/1 (icemaking head) <i>Self-contained only.</i>	400 up to 454 lbs (206kg)	A Air-cooled, self-contained	V Vision™	S RIDE™
HC Horizon Chewblet (1000, 1400, 1650 Series)	D 115/60/1 (icemaking head) <i>Self-contained and remote. If remote unit, high side is 208-230/60/1.</i>	1000 up to 1036 lbs (471kg)	W Water-cooled, self-contained	H Harmony™	H (RIDE remote ice delivery equipment)
HM Horizon Micro Chewblet	E 230/50/1 (icemaking head) <i>Self-contained only.</i>	1400 up to 1450 lbs (658kg)	R Air-cooled, remote condensing unit	B Ice storage bin	T Top-mount
	F 115/60/1 (icemaking head) <i>Remote only. High side is 208-230/60/3.</i>	1650 up to 1580 lbs (717kg)	N Air-cooled, no condensing unit for connection to parallel rack system	J Drop-in	
				M Ice Manager diverter valve system	

## Read and complete the following 8 installation steps

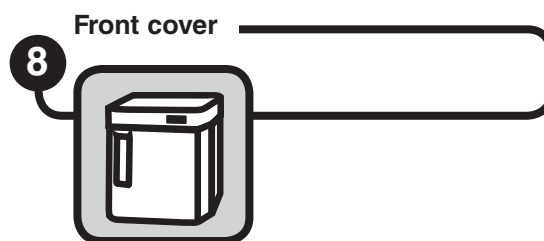
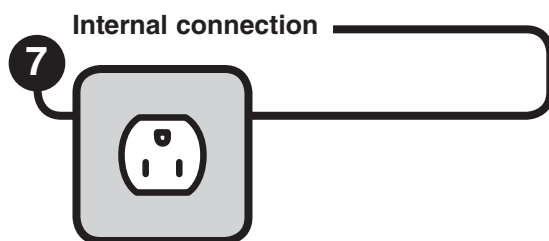
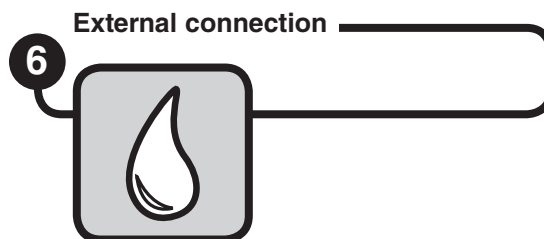
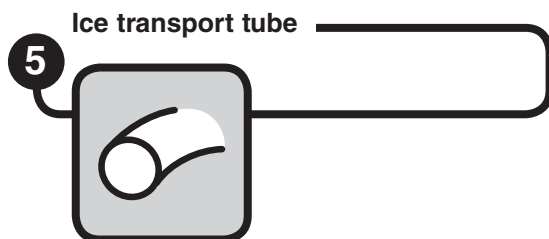
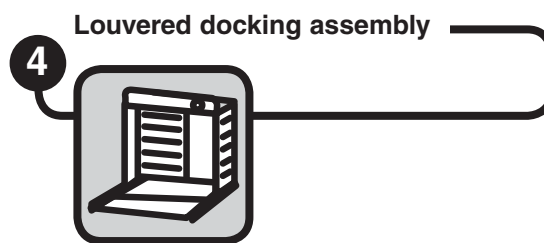
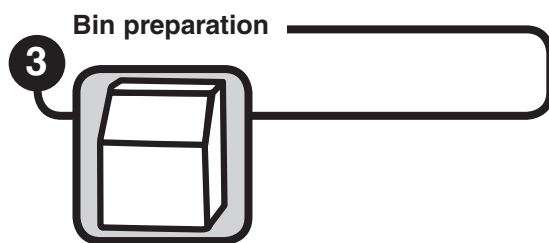
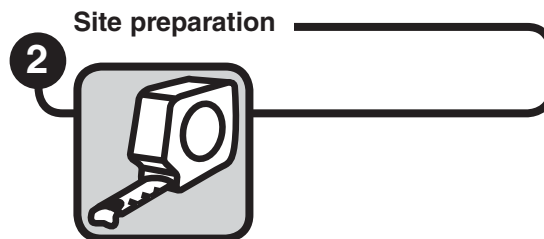
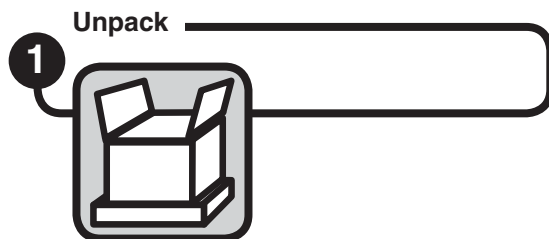

Carefully unpack and inspect the contents of your Follett ice machine.

Unpack

1



## 1.1 Unpack ice machine

1

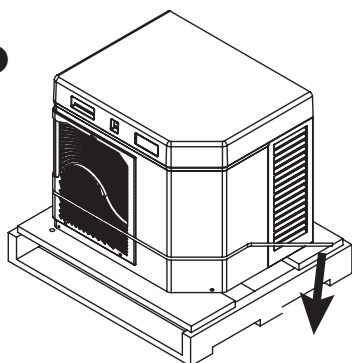

2

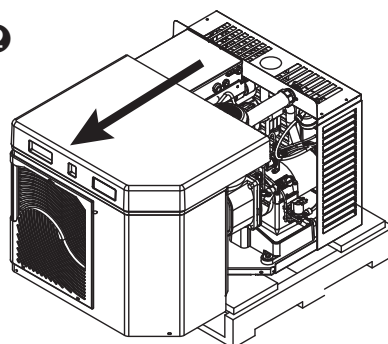

3

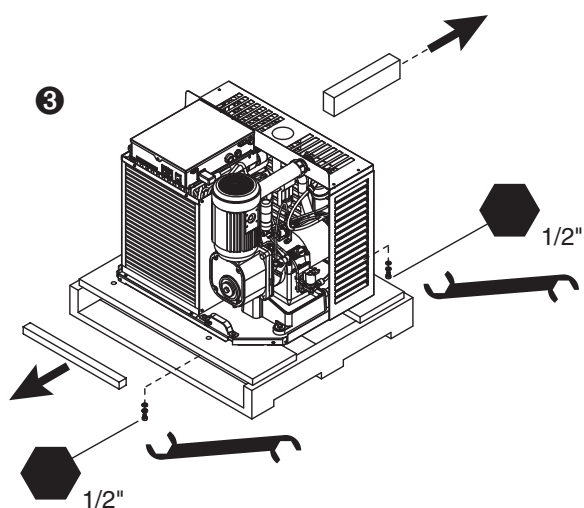

4

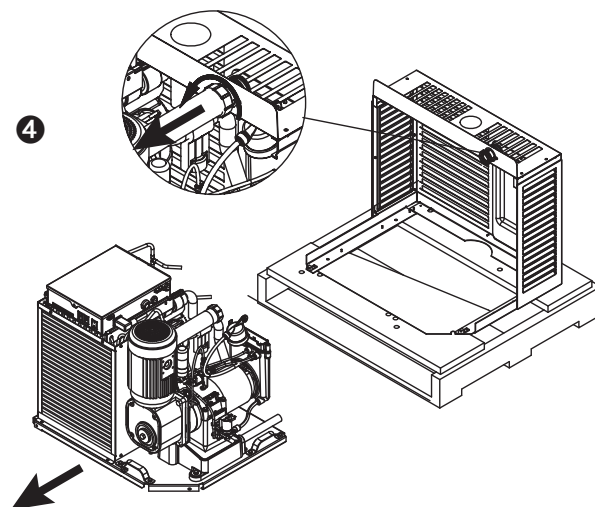

5

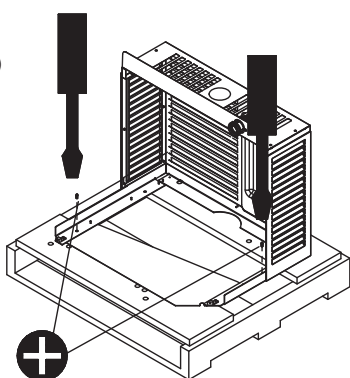

6

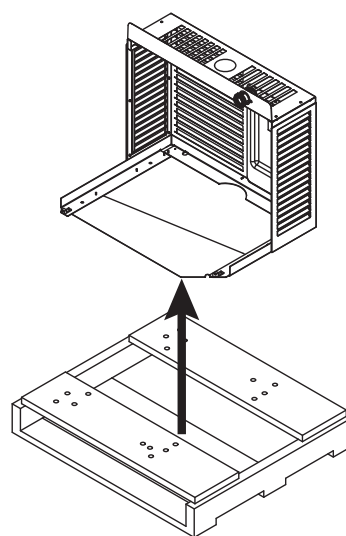

## Prepare the installation site.

## Site preparation

2

Provide drainage, water supply and electrical power to within 6 feet (2m) of ice machine in accordance with local and national codes. Outdoor installation is not recommended and will void warranty.

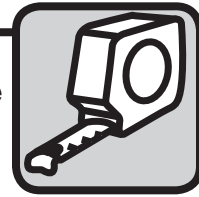

### 2.1 Installation site requirements

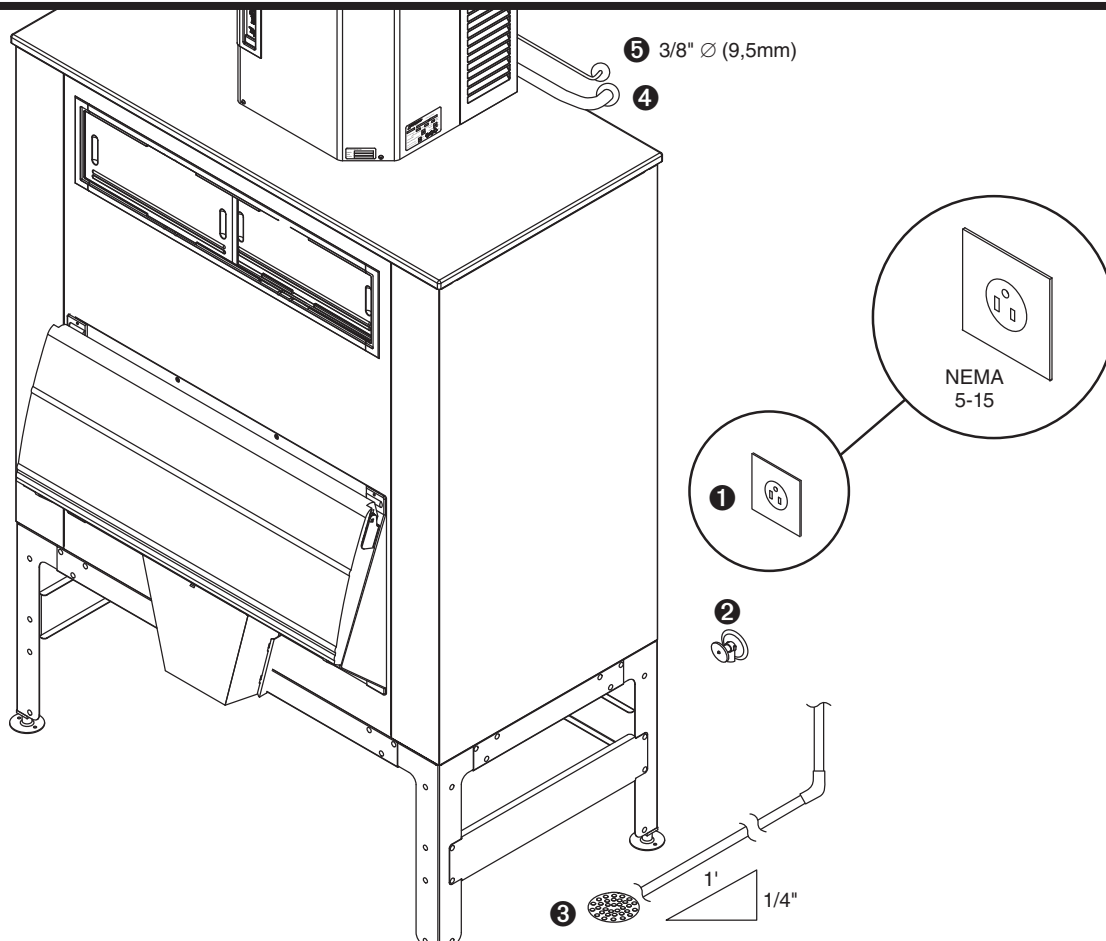

#### Electrical ①

120/60/1-6 amps

#### Potable water supply ②

- 10-70 psi (69-483kpa)
- 45-90 F (7-32 C)
- Follett recommends the use of an in-line water filtration system (item# 00130286)

#### Drain ③

- The drain line from the ice machine must have at least 1/4" per foot pitch (6,4mm/.3m)

#### Refrigeration lines ④

- 1000, 1400: 5/8" (15,8mm) diameter suction (insulated) ④
- 1650: 7/8" (22,2mm) diameter suction (insulated) ④
- 3/8" (9,5mm) liquid ⑤

Prepare the bin.

## Bin preparation

3

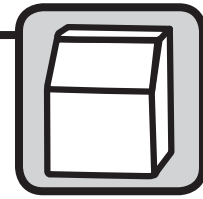

### 3.1 Bin top preparation

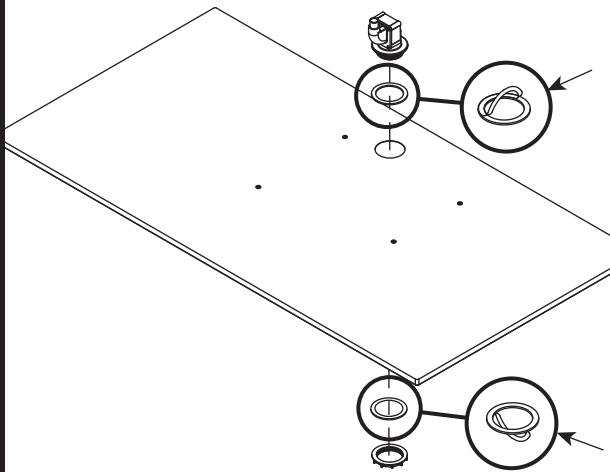

- Remove protective tape from gaskets

### 3.2 Bin top preparation

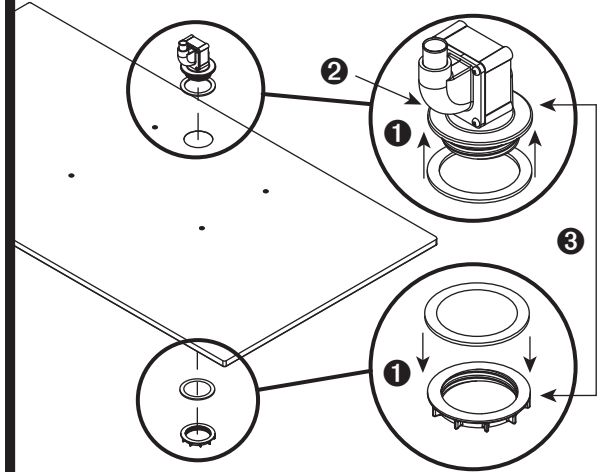

- Apply gaskets ①
- Install shuttle actuator ② through bin top and secure with locking nut ③

Install the louvered docking assembly.

## Louvered docking assembly

4



### 4.1 Louvered docking assembly

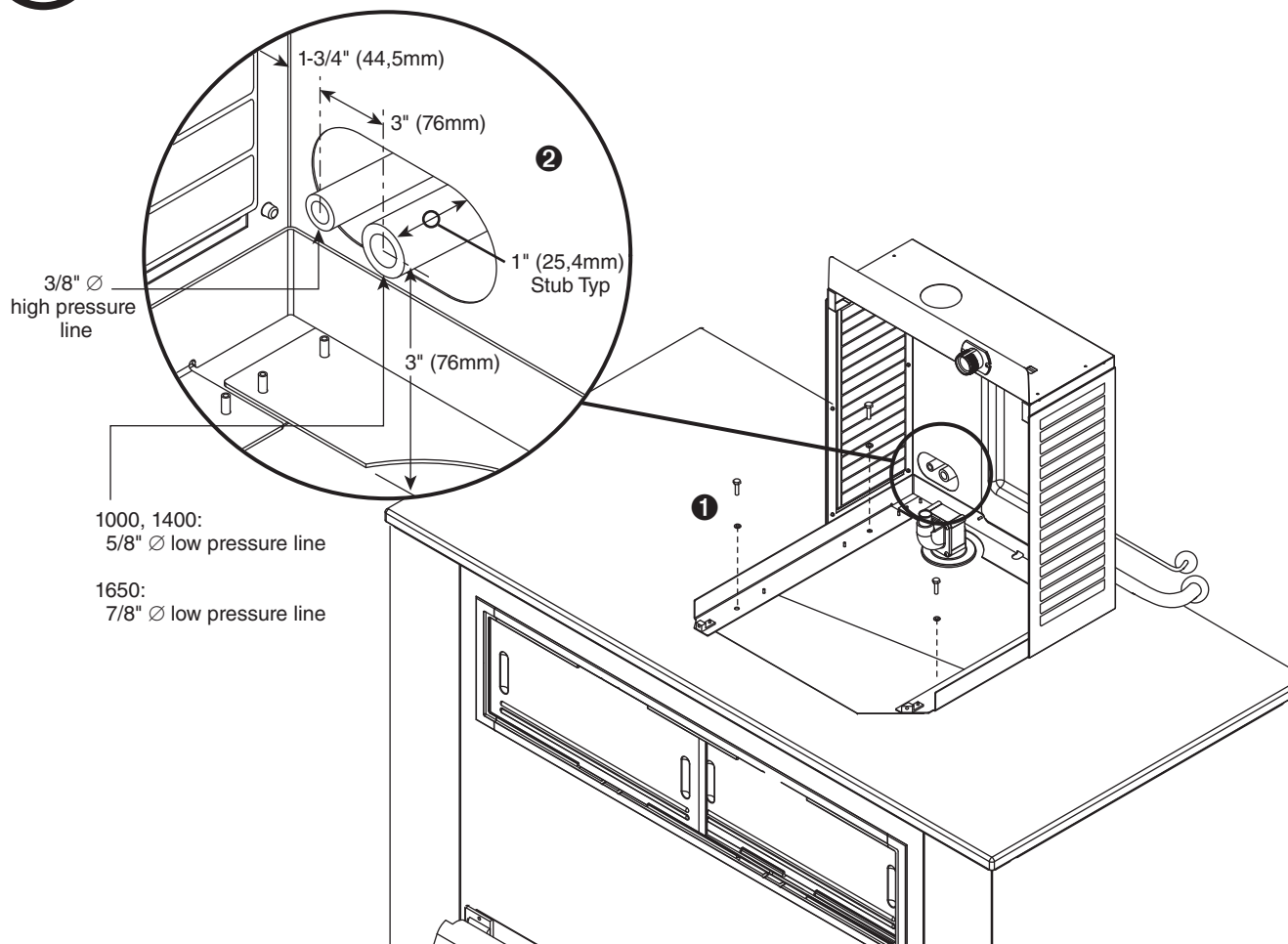

- Mount louvered docking assembly ①
- "Rough-in" the refrigerant piping ②

## 4.2

### Refrigerant lines

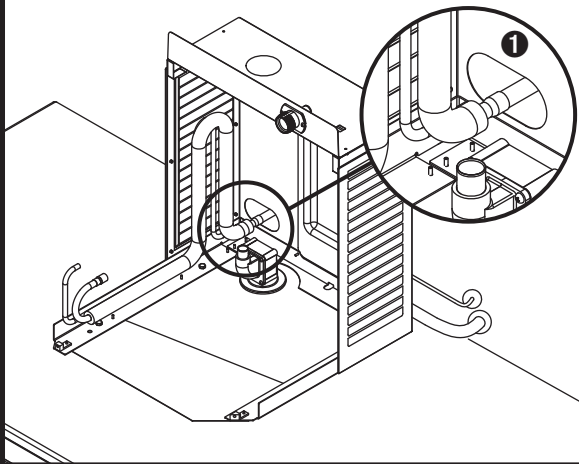

- Braze supplied expandable refrigerant lines in place ❶



Install the ice transport tube.

Ice transport tube

5



5.1

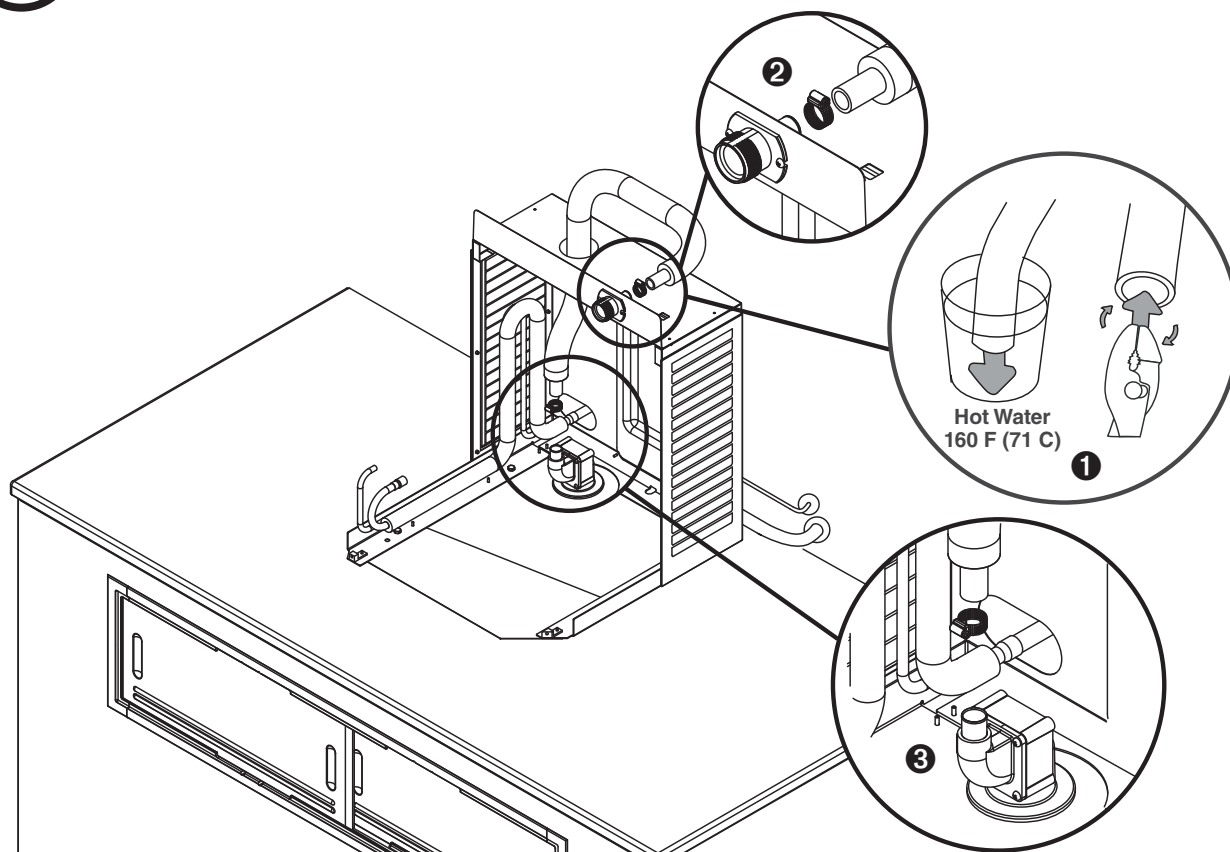

- Slide insulation onto ice transport tube
- Heat end of transport tube in cup of 160 F (71 C) hot water to soften and spread with pliers ❶ before making connection to ease assembly
- Connect ice transport tube to coupling on louvered docking station ❷
- Connect ice transport tube to shuttle actuator ❸

Connect utilities to louvered docking assembly.

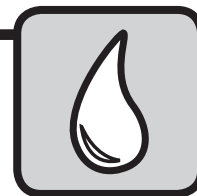
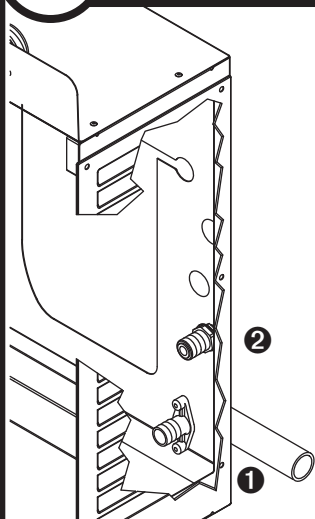
**6.1****Water and drain**

- Remove access panel if necessary.
- Install drain line ①.  
The rigid drain line from the ice machine must have at least 1/4" per foot pitch (6,4mm/0,3m).
- Install ice machine potable water supply ②
- Replace access panel

Connect louvered docking assembly to ice machine.

## Internal connections

7



### 7.1 Ice transport tube installation

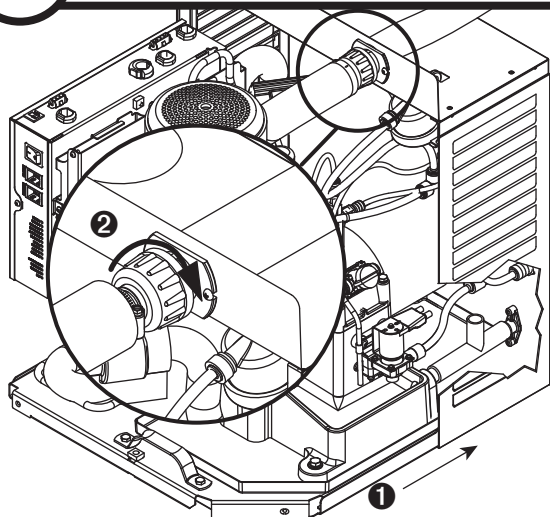

- Slide ice machine into louvered docking assembly **1**
- Insert ice transport tube all the way into coupling and tighten nut firmly **2**

### 7.2 Water and drain lines

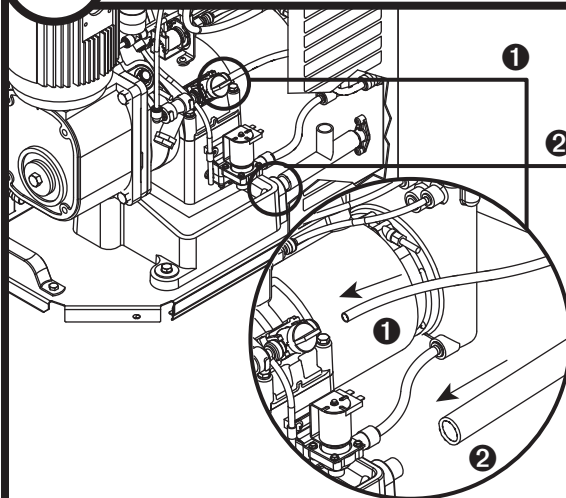

- Insert potable water line into valve **1**
- Push drain line over hose barb on back of evaporator mount **2**

### 7.3 Refrigeration lines

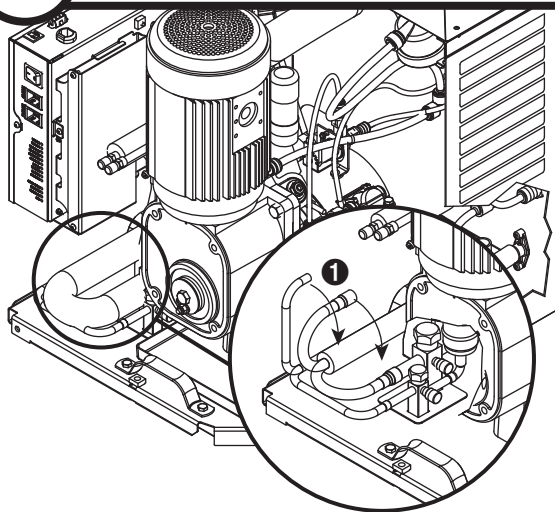

- Rotate and braise refrigerant lines **1**

### 7.4 Power cord

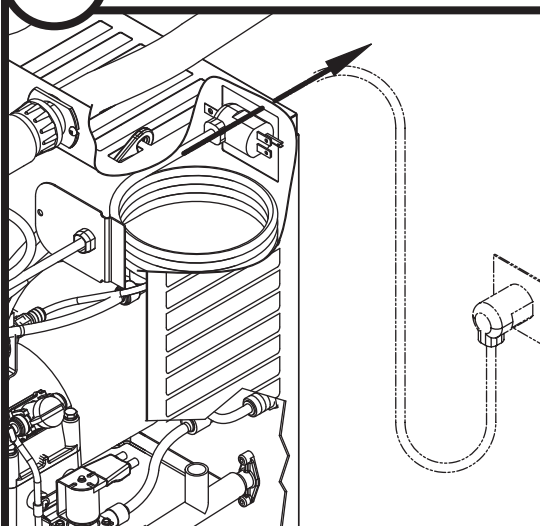

- Remove twist tie
- Carefully pass plug thru opening and plug into wall outlet

7.5

#### Power cord

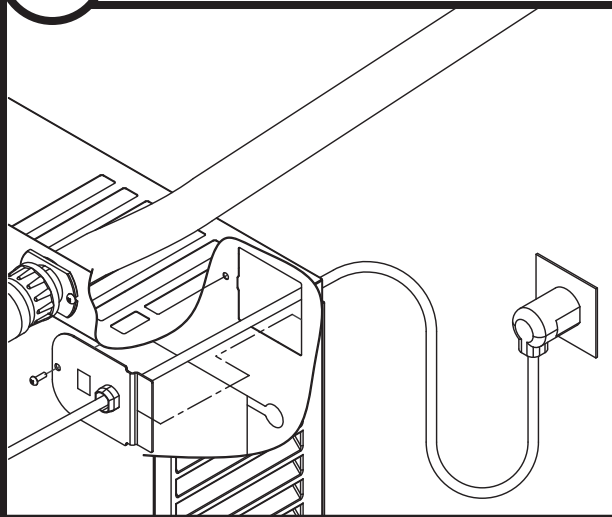

- Position plate into opening and secure with supplied screw



Install front cover to ice machine.

Front cover

8



### 8.1 Install condensing unit

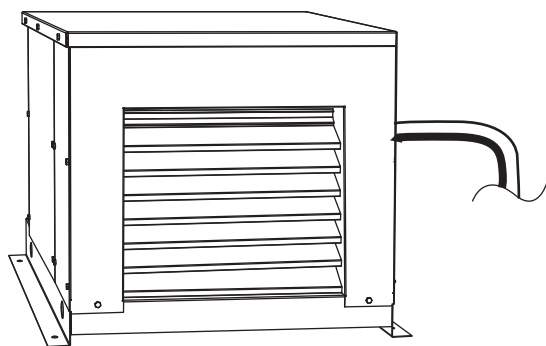

- Complete installation of condensing unit or connection to rack system.

### 8.2 Install ice machine front cover

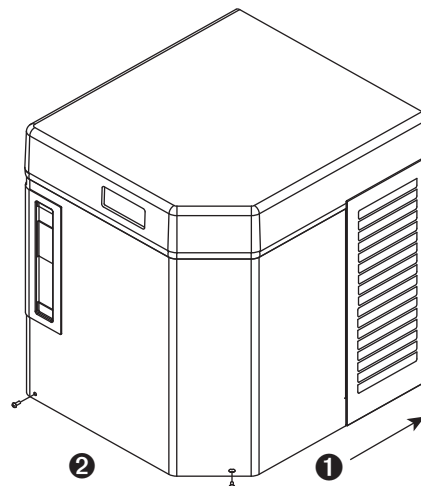

- Slide ice machine cover over machine ensuring that tabs on back of cover slip under louvers on back of louvered docking assembly ①
- Insert and tighten two screws through cover and into louvered docking assembly ②

### NOTICE

**Ice machine MUST be sanitized prior to operation!**

Consult Operation and Service Manual provided with ice machine for sanitizing instructions.



Horizon, Maestro, Harmony, Ice Manager, SafeCLEAN, Sani-Sponge, RIDE and Vision are trademarks of Follett Corporation.  
Chewblat is a registered trademark of Follett Corporation, registered in the US.



801 Church Lane • Easton, PA 18040, USA  
Toll free (877) 612-5086 • +1 (610) 252-7301  
[www.follettice.com](http://www.follettice.com)



00159962R08  
3/12