

# Horizon™ Ice Machine Installation Instructions for Harmony™ Top-mount Applications

HCD/HMD/HCF/HMF1000RHT, HCD/HMD/HCF/HMF1400RHT, HCD/HMD/HCF/HMF1650RHT,  
HCD/HMD1000NHT, HCD/HMD1400NHT, HCD/HMD1650NHT  
(See model number configurator on page 2 for details.)

Order parts online  
[www.follettice.com](http://www.follettice.com)

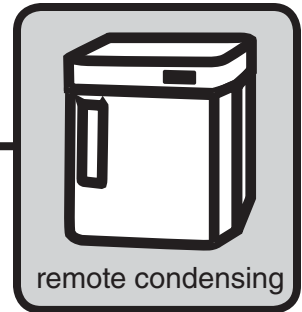

**Horizon top-mount ice machines  
fit most countertop dispensers manufactured by  
Cornelius • Lancer • SerVend**

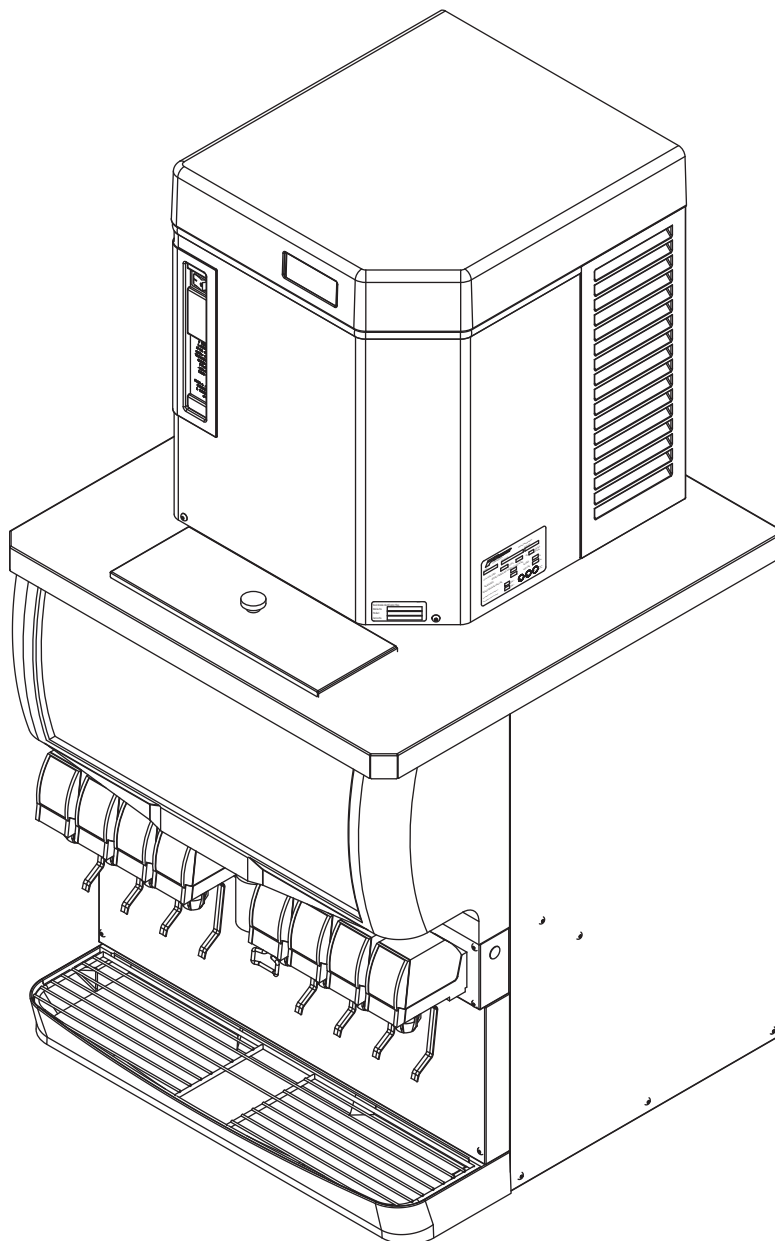

## Chewblet® Ice Machine Model Number Configurations

<div style="display: flex; justify-content: space-around; align-items: center;"> <div style="border: 1px solid black; padding: 2px 5px;">HC</div> <div style="border: 1px solid black; padding: 2px 5px;">C</div> <div style="border: 1px solid black; padding: 2px 5px;">1400</div> <div style="border: 1px solid black; padding: 2px 5px;">A</div> <div style="border: 1px solid black; padding: 2px 5px;">V</div> <div style="border: 1px solid black; padding: 2px 5px;">S</div> </div>					
Icemaker	Voltage	Series	Condenser	Application	Configuration
MC Maestro™ Chewblet® (400 Series)	C 208-230/60/1 (icemaking head) <i>Self-contained only.</i>	400 up to 454 lbs (206kg)	A Air-cooled, self-contained	V Vision™	S RIDE™
HC Horizon Chewblet (1000, 1400, 1650 Series)	D 115/60/1 (icemaking head) <i>Self-contained and remote. If remote unit, high side is 208-230/60/1.</i>	1000 up to 1036 lbs (471kg)	W Water-cooled, self-contained	H Harmony™	(RIDE remote ice delivery equipment)
HM Horizon Micro Chewblet	E 230/50/1 (icemaking head) <i>Self-contained only.</i>	1400 up to 1450 lbs (658kg)	R Air-cooled, remote condensing unit	B Ice storage bin	T Top-mount
	F 115/60/1 (icemaking head) <i>Remote only. High side is 208-230/60/3.</i>	1650 up to 1580 lbs (717kg)	N Air-cooled, no condensing unit for connection to parallel rack system	J Drop-in	
				M Ice Manager diverter valve system	

## Read and complete the following 8 installation steps

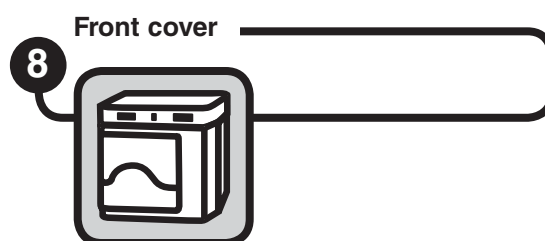
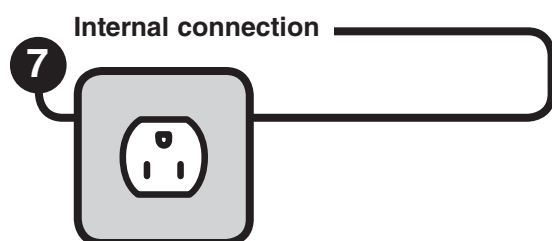
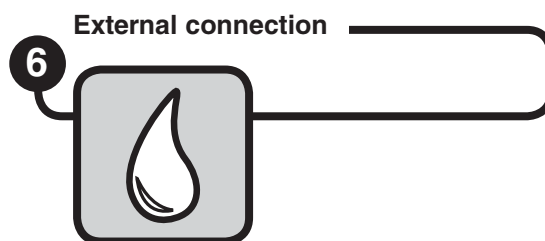
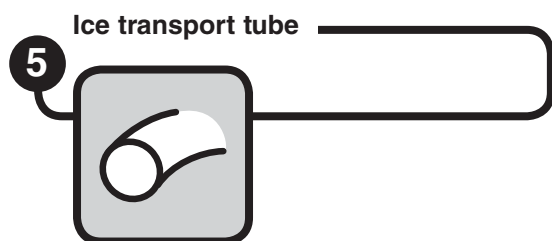
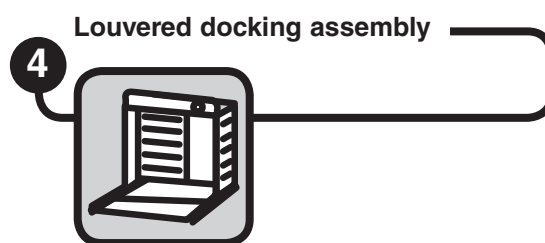
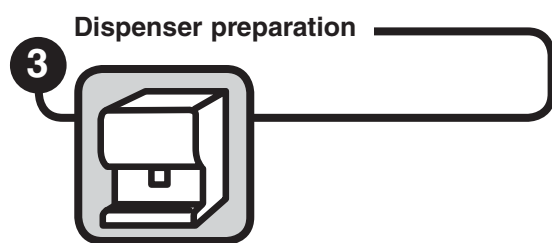
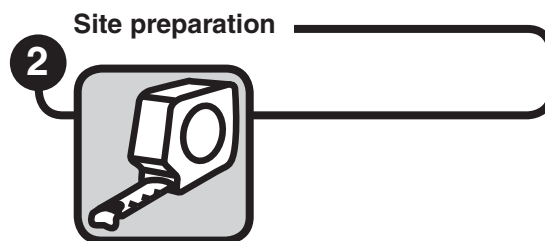
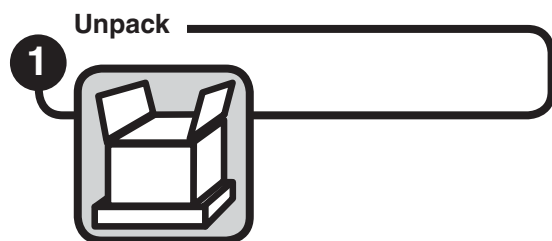

Carefully unpack and inspect the contents of your Follett ice machine.

Unpack

1



## 1.1 Unpack ice machine

1

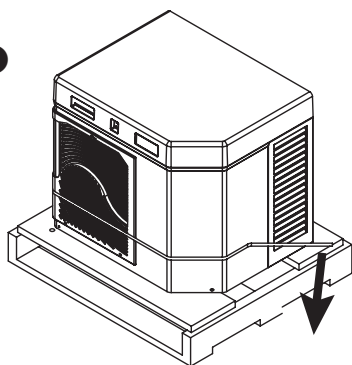

2

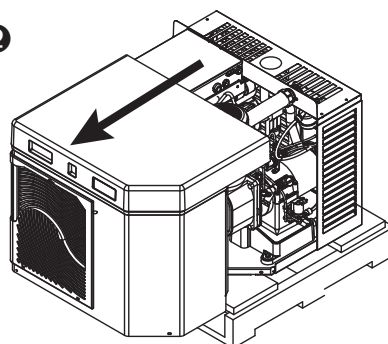

3

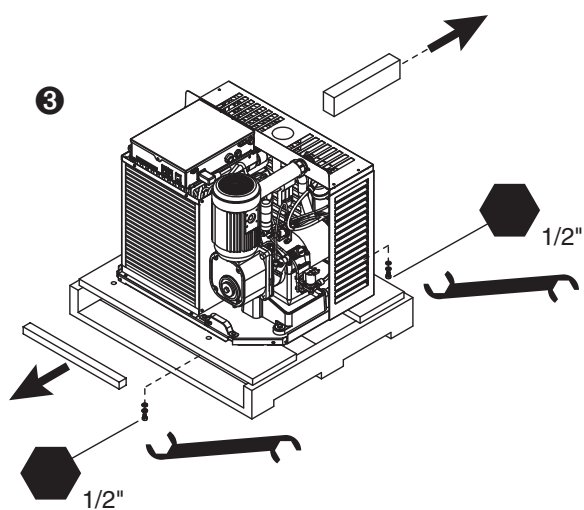

4

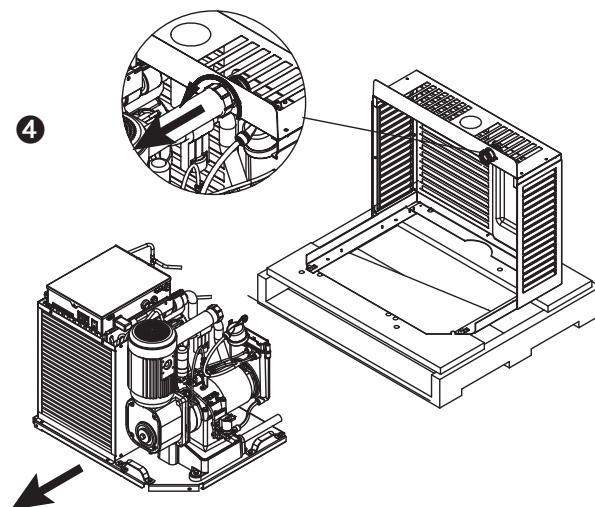

5

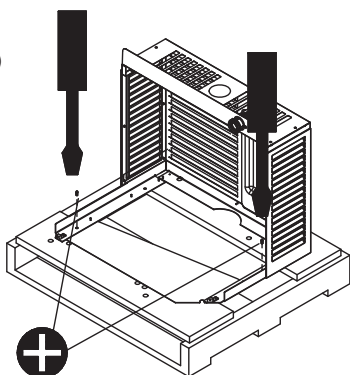

6

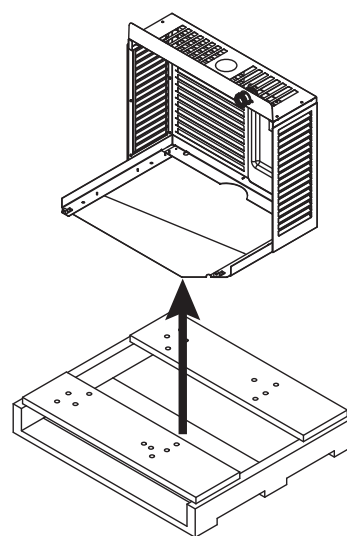

## Prepare the installation site.

## Site preparation

2

Provide drainage, water supply and electrical power to within 6 feet (2m) of ice machine in accordance with local and national codes. Outdoor installation of low side is not recommended and will void warranty.

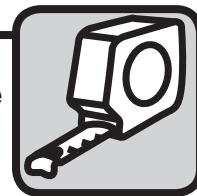

### 2.1 Installation site requirements

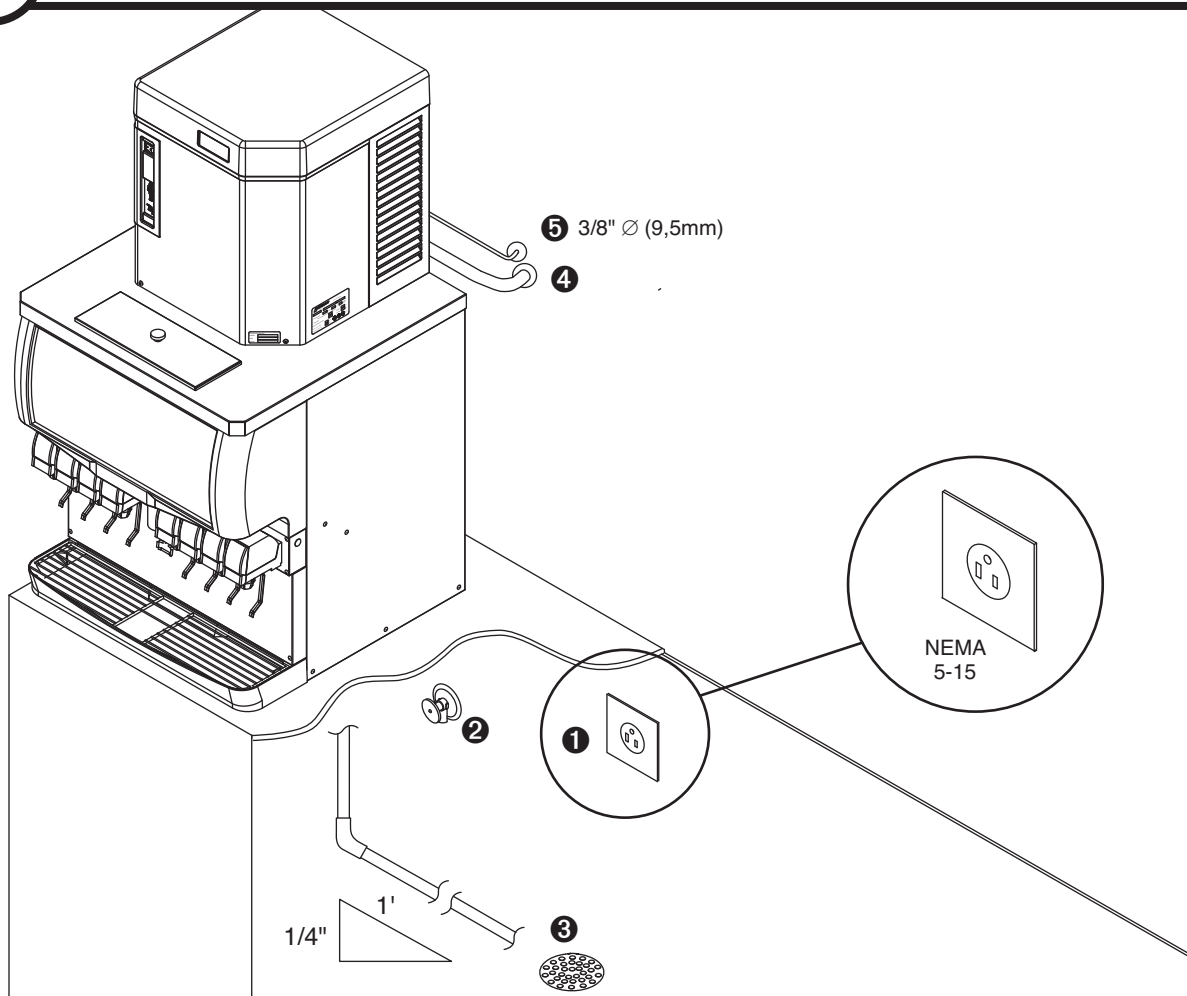

#### Electrical ①

- 120/60/1-6 amps

#### Potable water supply ②

- 10-70 psi (69-483kpa)
- 45-90 F (7-32 C)
- Follett recommends the use of an in-line water filtration system (item# 00130286)

#### Drain ③

- The drain line from the ice machine must have at least 1/4" per foot pitch (6,4mm/0,3m)

#### Refrigeration lines ④

- 1000, 1400: 5/8" (15,8mm) diameter suction (insulated) ④
- 1650: 7/8" (22,2mm) diameter suction (insulated) ④
- 3/8" (9,5mm) liquid ⑤

## Prepare the dispenser.

## Dispenser preparation

3

**Note:** The instructions below only apply to 22" & 30" wide dispensers.  
44" wide dispenser instructions may be found with the top kit.



### 3.1 Top preparation – ALL

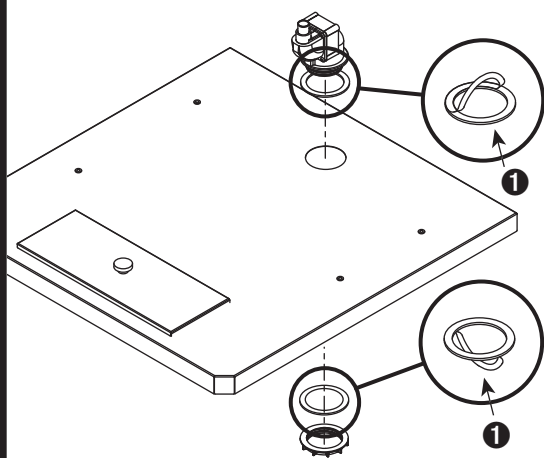

#### All models

- Remove protective tape from gaskets **1**

### 3.2 Top preparation – ALL

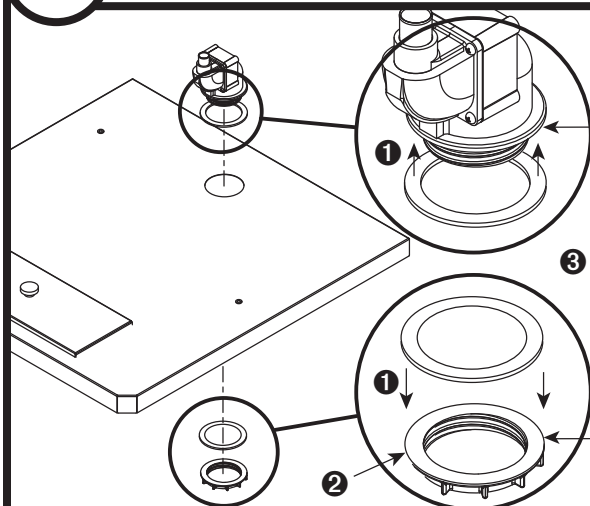

- Apply gaskets **1**
- Install shuttle actuator **2** through bottom of dispenser top and secure with locking nut **3**

### 3.3 Top preparation – ALL

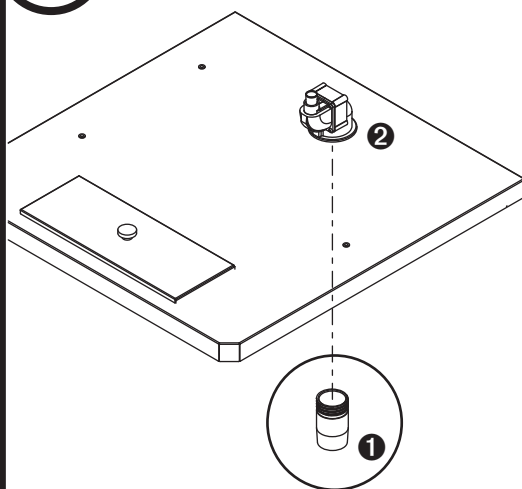

- Screw 4" (102mm) extension **1** into bottom of shuttle actuator **2**

### 3.4 Top preparation – CORNELIUS

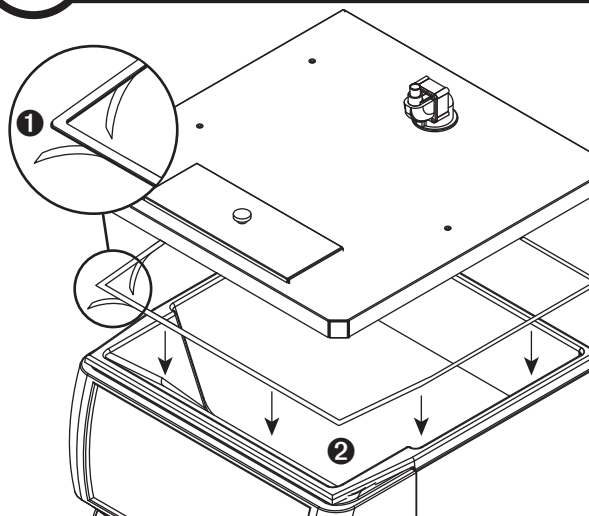

#### Cornelius models only

- Remove protective tape **1**
- Apply gasket **2**

### 3.5 Top preparation – LANCER

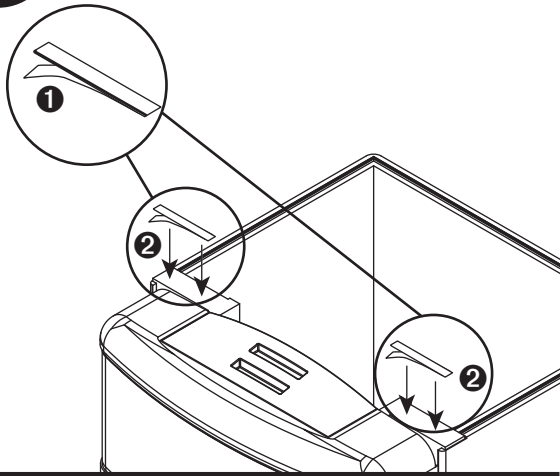

#### Lancer models only

- Remove protective tape ①
- Apply gaskets ②

### 3.6 Agitation adjust. – CORNELIUS

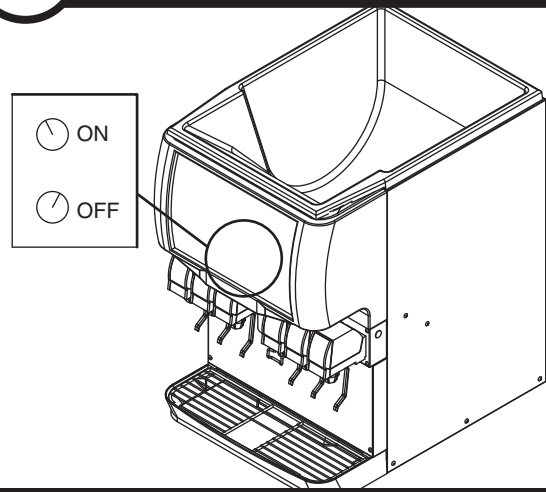

#### Cornelius models ED, DB, DF, IDC and FLAVOR FUSION

Adjust the agitation timer located on the Cornelius PC board to 1 second on, 1 hour off. **Note:** See Cornelius manual for more information.

### 3.7 Agitation adjustments – LANCER 4500 SERIES

PRESS IN ON THIS SIDE TO TURN SWITCH OFF.

ROCKER SWITCHES (VIEW LOOKING DOWN)

PRESS IN ON THIS SIDE TO TURN SWITCH ON.

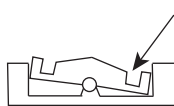
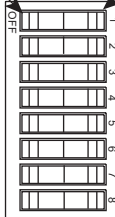

SWITCH ON

SWITCH OFF

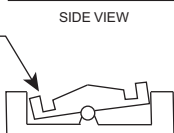

SIDE VIEW

SWITCH NUMBER	AGITATION TIME			
	1 SECOND	2 SECONDS	3 SECONDS	4 SECONDS
3	O	O	X	X
4	O	X	O	X

X = ON  
O = OFF

SWITCH NUMBER	AGITATION FREQUENCY														
	NO AGITATION	10 MINUTES	20 MINUTES	30 MINUTES	40 MINUTES	50 MINUTES	60 MINUTES	70 MINUTES	80 MINUTES	90 MINUTES	100 MINUTES	110 MINUTES	120 MINUTES	130 MINUTES	140 MINUTES
5	O	O	O	O	O	O	O	X	X	X	X	X	X	X	X
6	O	O	O	O	X	X	X	X	O	O	O	O	X	X	X
7	O	O	X	X	O	O	X	X	O	X	X	O	O	X	X
8	O	X	O	X	O	X	O	X	O	X	O	X	O	X	X

#### Lancer 4500 series only

Adjust the agitation time to 1 second, and the agitation frequency to 150 minutes.

**Note:** See Lancer manual for more information.

### 3.8 Agitation adjustments – LANCER FS SERIES

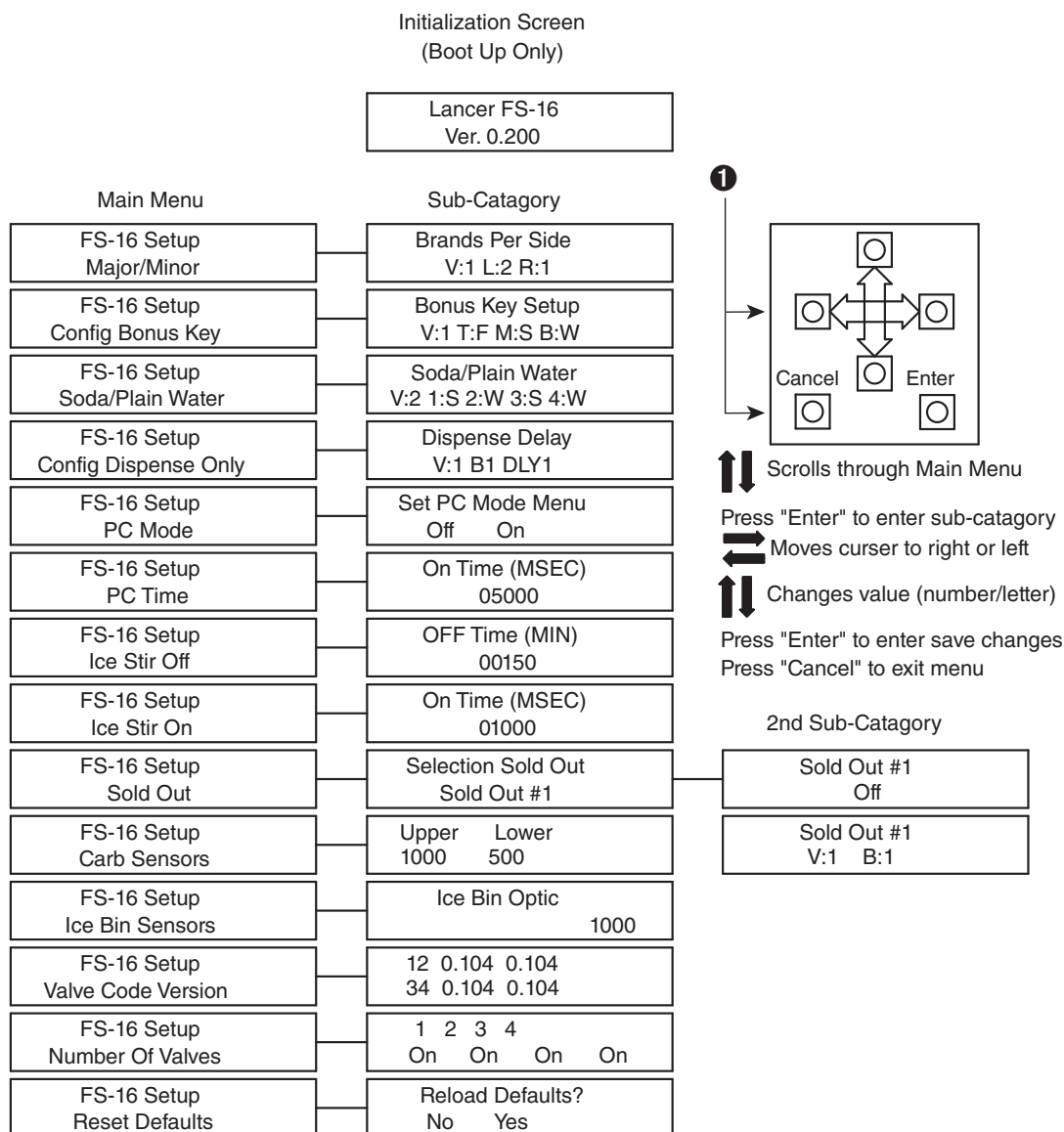

#### Lancer FS series only

- Hold down "cancel" and "left button" to get to hidden menu ①
- Type in code 6655
- Type in 150 minutes of off time and 1000 milliseconds (1 second of time) as the preferred setting

**Note:** See Lancer manual for more information.

### 3.9 Agitation adjustments – SERVEND

#### SerVend models only

No agitation adjustment required.

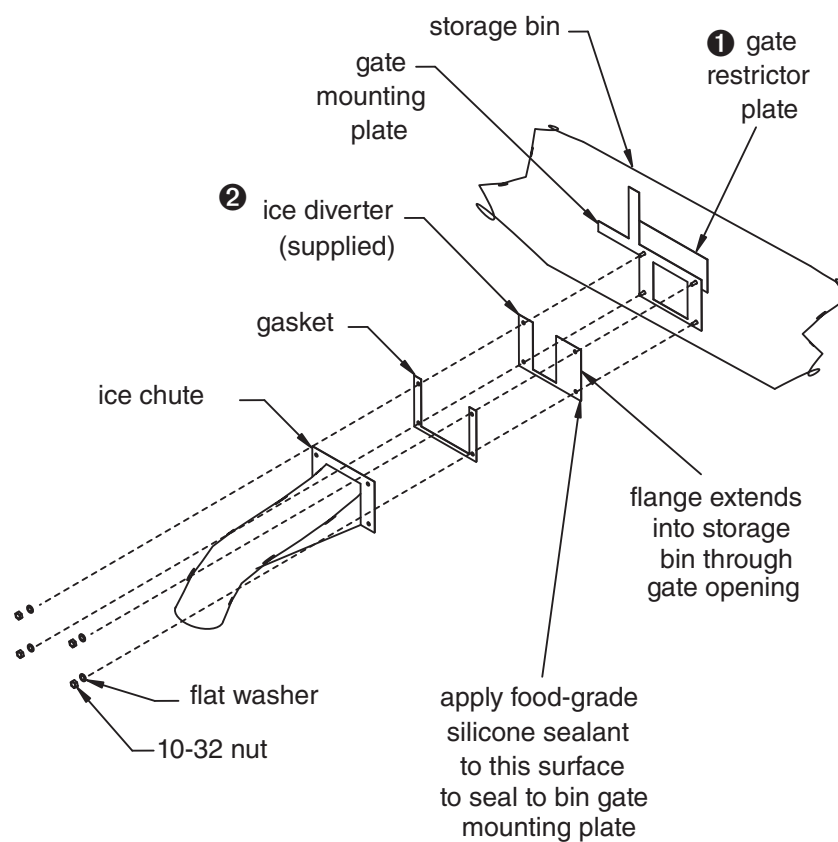
**3.10****Dispenser diverter plate installation – CORNELIUS ED, DF and DB SERIES****Cornelius ED, DF and DB series only**

These dispensers require the installation of an ice diverter at the dispenser opening.

- Disassemble chute assembly
- Discard factory restrictor plate ①
- Replace with alternate diverter plate, ② (supplied)

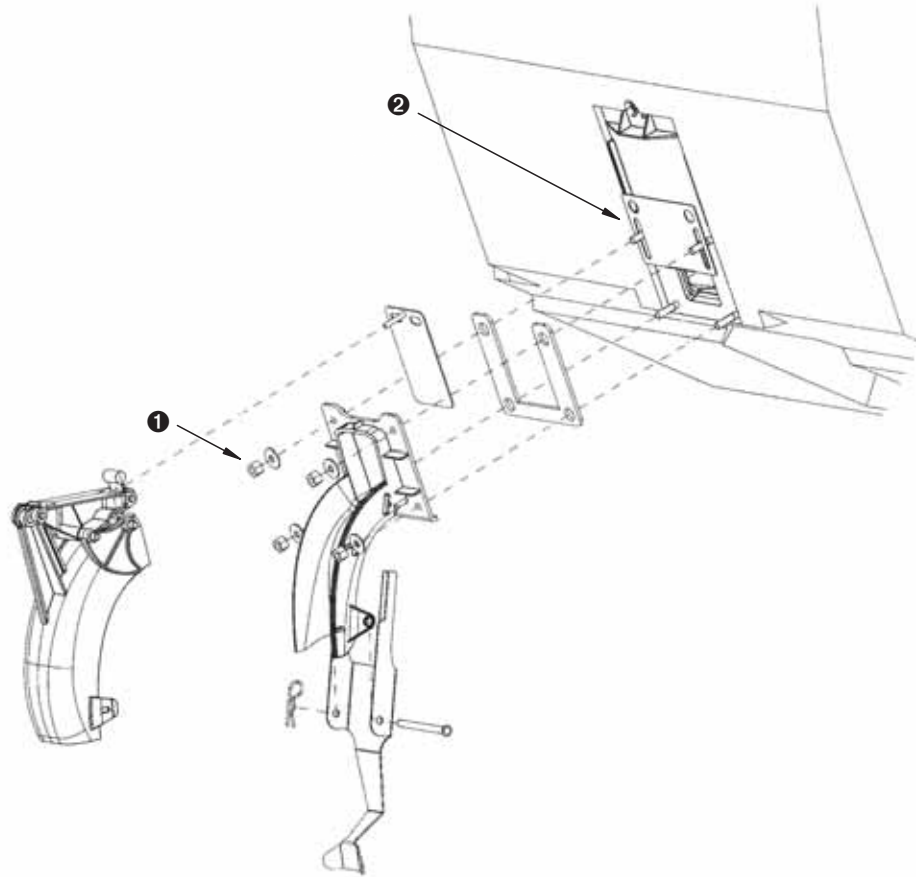
**Cornelius IDC and Flavor Fusion**

These dispensers require the adjustment of the ice restrictor plate.

- Loosen four nuts on ice chute assembly ①
- Adjust restrictor plate to fully open position ②
- Replace four nuts and tight to 50 in lbs (max.)



Install the louvered docking assembly.

## Louvered docking assembly

4



### 4.1 Louvered docking assembly

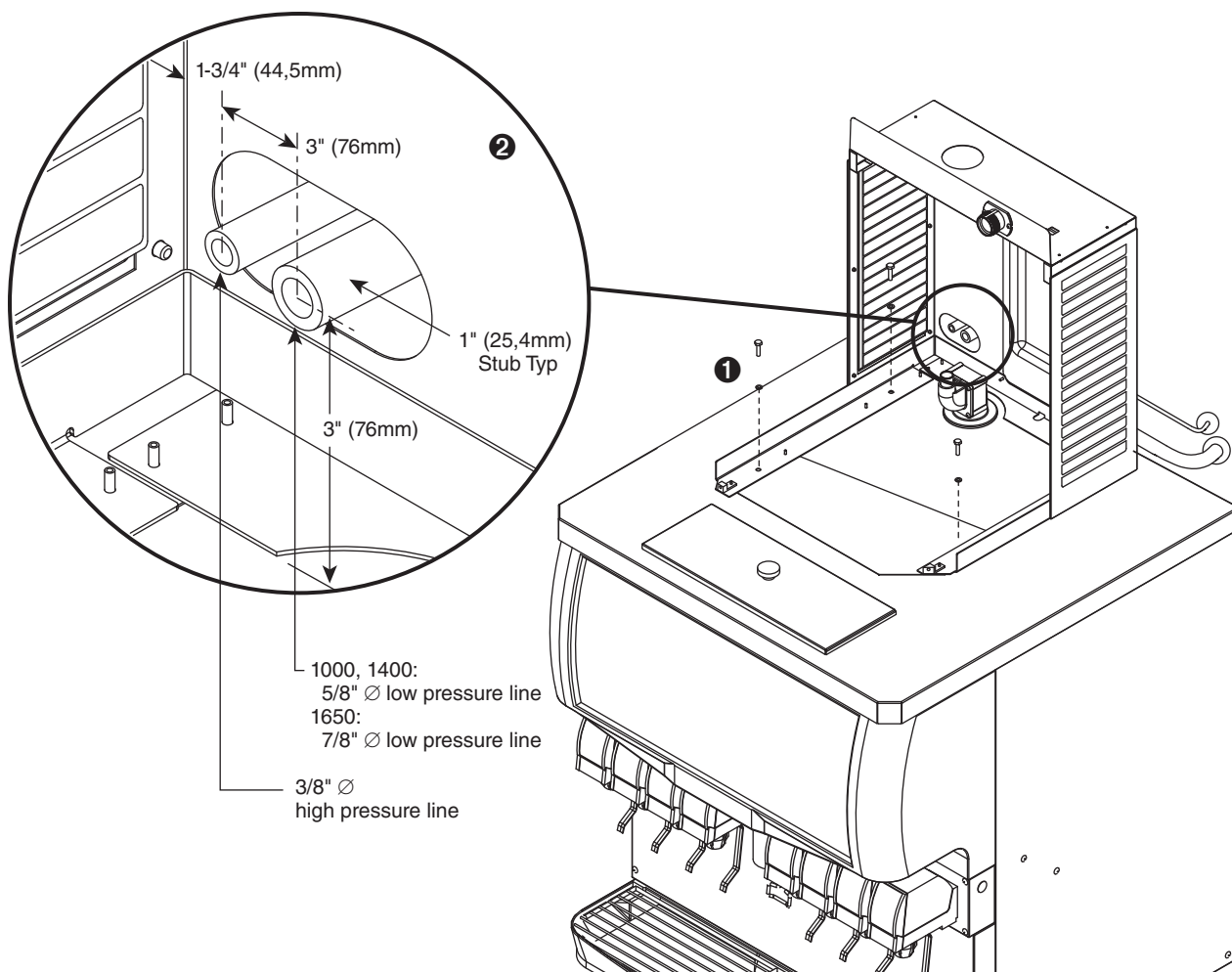

- Mount louvered docking assembly ①
- "Rough-in" the refrigerant piping ②

## 4.2

### Refrigerant lines

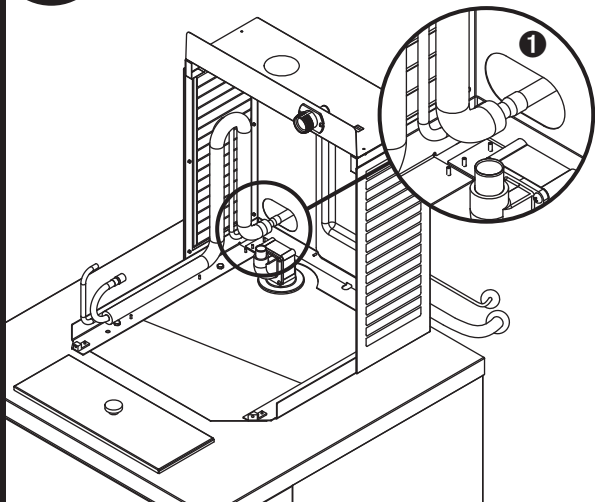

- Braze supplied expandable refrigerant lines in place ①

Install the ice transport tube.

Ice transport tube

5



### 5.1 Ice transport tube

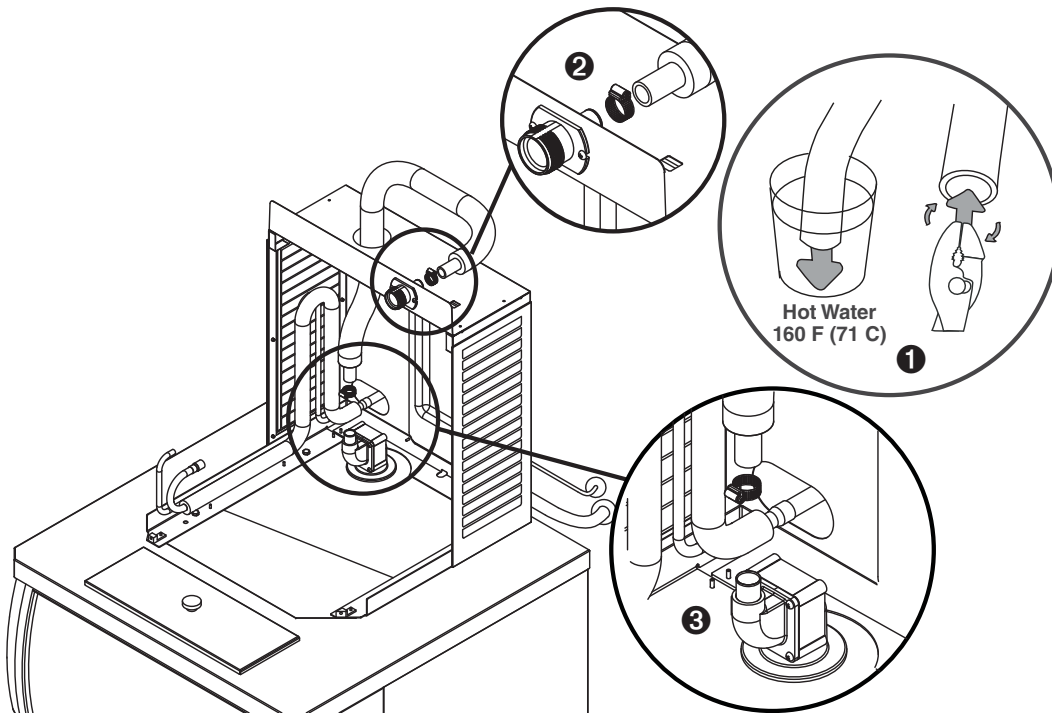

- Install supplied ice transport tube installation
- Heat end of transport tube in cup of 160 F (71 C) hot water to soften and spread with pliers ❶ before making connection to ease assembly
- Connect ice transport tube to coupling on louvered docking station ❷
- Connect ice transport tube to shuttle actuator ❸

Connect utilities to louvered docking assembly.

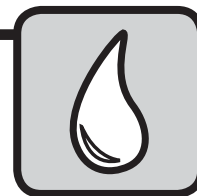
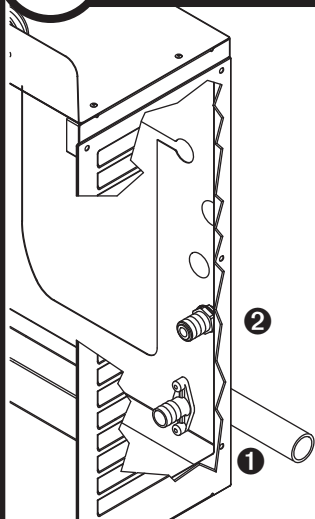
**6.1****Water and drain**

- Remove access panel if necessary.
- Install drain line ①.  
The rigid drain line from the ice machine must have at least 1/4" per foot pitch (6,4mm/0,3m).
- Install ice machine potable water supply ②
- Replace access panel

Connect louvered docking assembly to ice machine.

## Internal connections

7



### 7.1 Ice transport tube installation

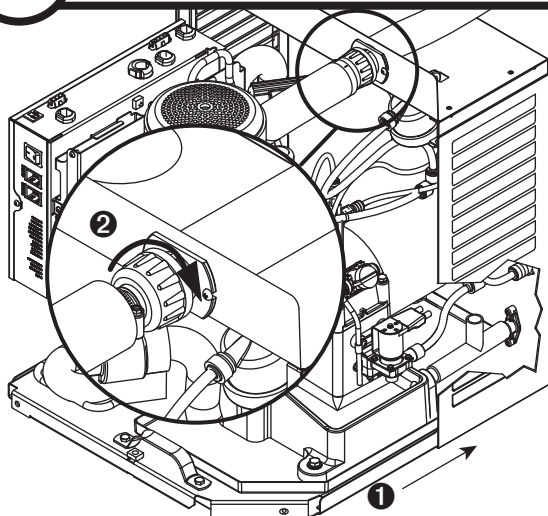

- Slide ice machine into louvered docking assembly **1**
- Insert ice transport tube all the way into coupling and tighten nut firmly **2**

### 7.2 Water and drain lines

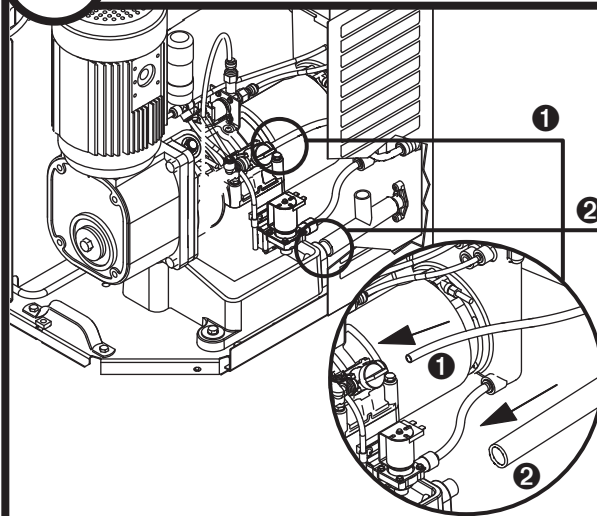

- Insert potable water line into valve **1**
- Push drain line over hose barb on back of evaporator mount **2**

### 7.3 Refrigeration lines

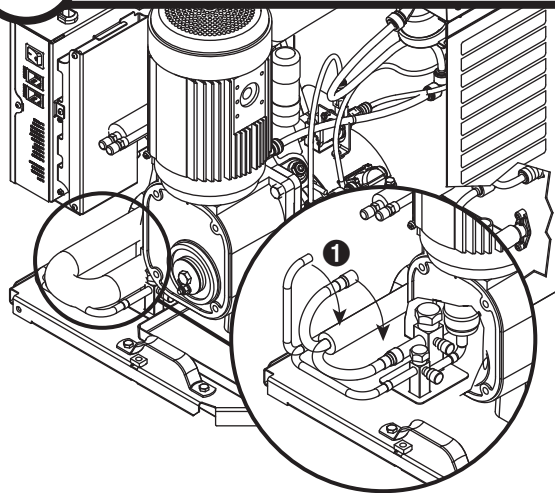

- Rotate and braise refrigerant lines **1**

### 7.4 Power cord

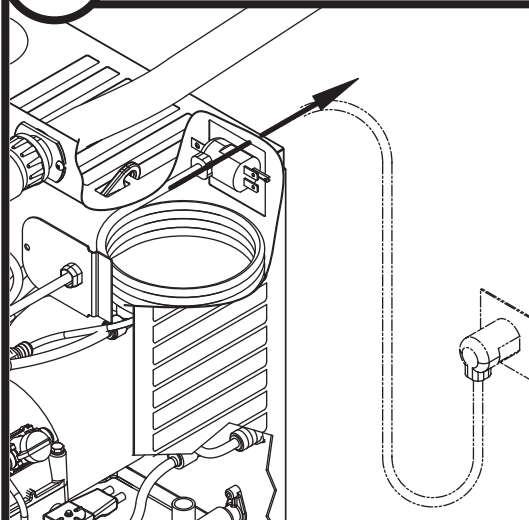

- Remove twist tie
- Carefully pass plug thru the opening and plug into wall outlet

7.5

## Power cord

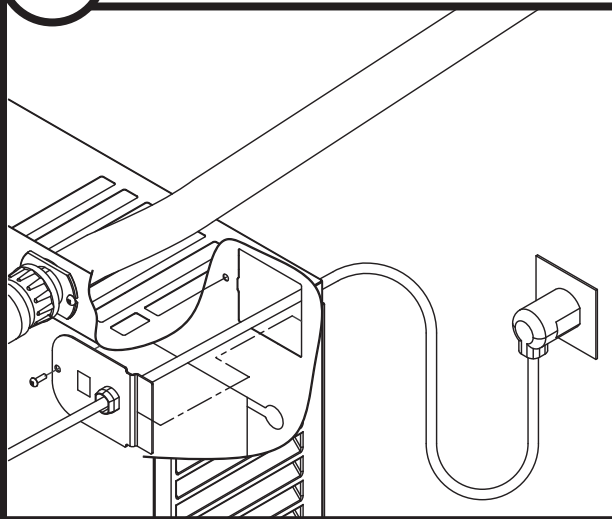

- Position plate into opening and secure with supplied screw

Install front cover to ice machine.

Front cover

8



### 8.1 Install condensing unit

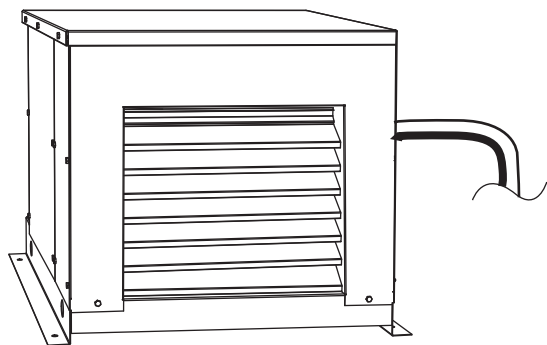

- Complete installation of condensing unit or connection to rack system.

### 8.2 Install ice machine front cover

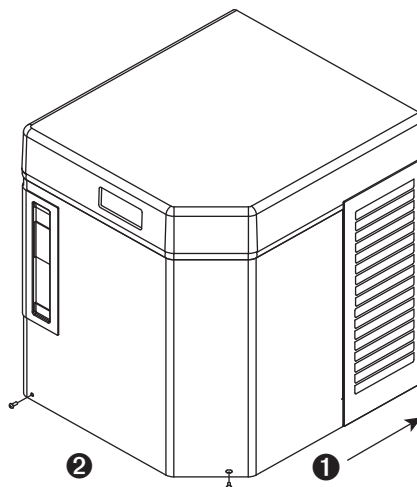

- Slide ice machine cover over machine ensuring that tabs on back of cover slip under louvers on back of louvered docking assembly ①
- Insert and tighten two screws through cover and into louvered docking assembly ②

### NOTICE

**Ice machine MUST be sanitized prior to operation!**

Consult Operation and Service Manual provided with ice machine for sanitizing instructions.



Horizon, Maestro, Harmony, Ice Manager, SafeCLEAN, Sani-Sponge, RIDE and Vision are trademarks of Follett Corporation.  
Chewblet is a registered trademark of Follett Corporation, registered in the US.



801 Church Lane • Easton, PA 18040, USA  
Toll free (877) 612-5086 • +1 (610) 252-7301  
[www.follettice.com](http://www.follettice.com)



00159970R06  
3/12