

Horizon Elite™ Ice Machine Installation Instructions to Ice Storage Bin Top-mount Applications

H_C1010ABT, H_C1010WBT,
H_C1410ABT, H_C1410WBT,
(See model number configurator on page 2 for details.)

Order parts online
www.follettice.com

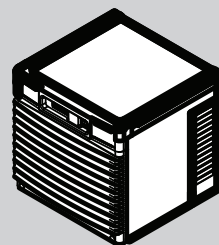

self-contained

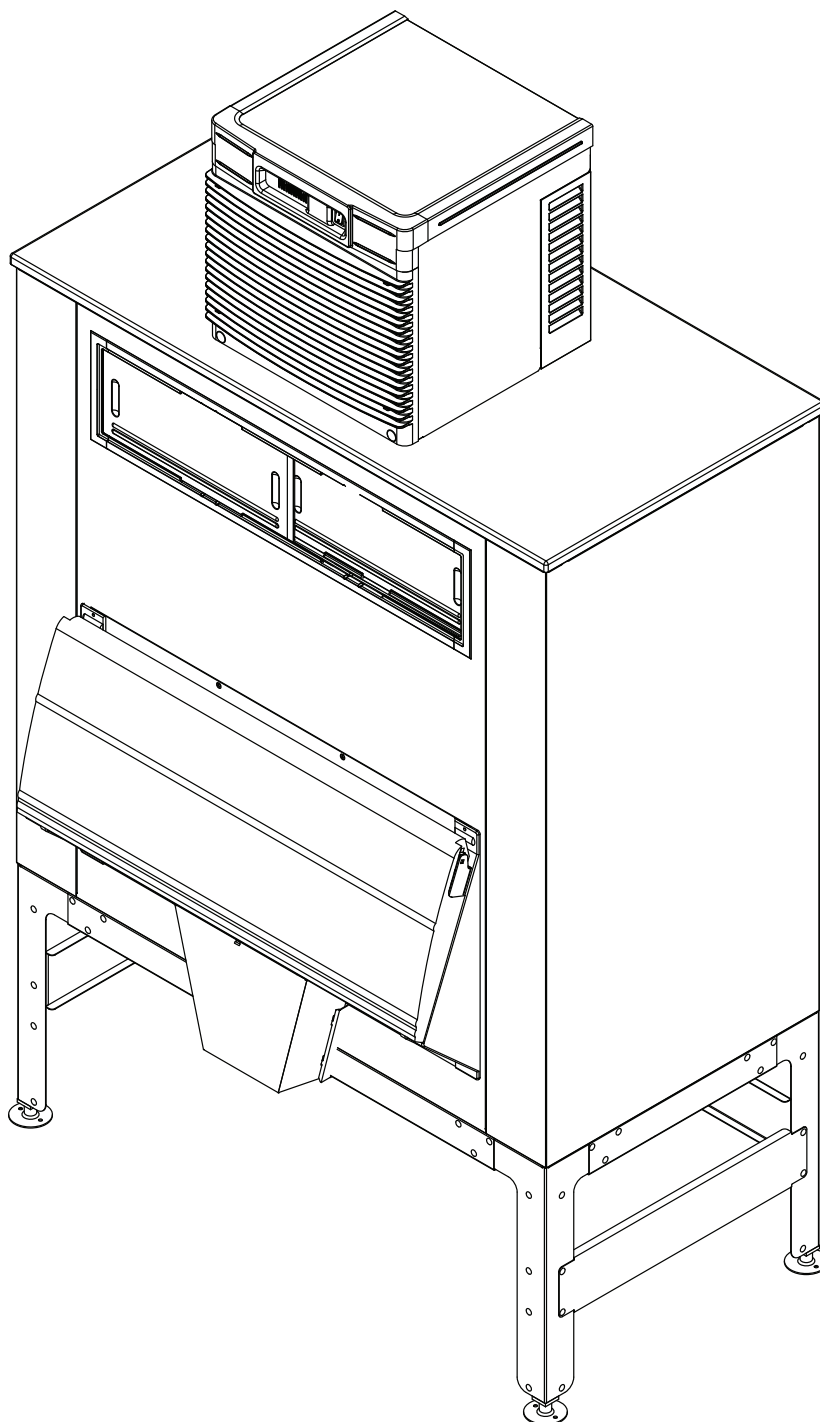

Chewblet® Ice Machine Model Number Configurations

<div style="display: flex; justify-content: space-around; align-items: center;"> <div style="border: 1px solid black; padding: 2px 5px;">HC</div> <div style="border: 1px solid black; padding: 2px 5px;">C</div> <div style="border: 1px solid black; padding: 2px 5px;">1400</div> <div style="border: 1px solid black; padding: 2px 5px;">A</div> <div style="border: 1px solid black; padding: 2px 5px;">V</div> <div style="border: 1px solid black; padding: 2px 5px;">S</div> </div>					
Icemaker	Voltage	Series	Condenser	Application	Configuration
MC Maestro™ Chewblet® (400 Series)	C 208-230/60/1 (icemaking head) <i>Self-contained only.</i>	400 up to 454 lbs (206kg)	A Air-cooled, self-contained W Water-cooled, self-contained	V Vision™ H Harmony™	S RIDE™ <i>(RIDE remote ice delivery equipment)</i>
HC Horizon Chewblet (1000, 1400, 1650 Series)	D 115/60/1 (icemaking head) <i>Self-contained and remote. If remote unit, high side is 208-230/60/1.</i>	1000/1010 up to 1036 lbs (471kg)	R Air-cooled, remote condensing unit N Air-cooled, no condensing unit for connection to parallel rack system	B Ice storage bin J Drop-in M Ice Manager diverter valve system	T Top-mount
HM Horizon Micro Chewblet	E 230/50/1 (icemaking head) <i>Self-contained only.</i> F 115/60/1 (icemaking head) <i>Remote only. High side is 208-230/60/3.</i>	1400/1410 up to 1450 lbs (658kg) 1650 up to 1580 lbs (717kg)			

CAUTION!

- This appliance should be connected by a qualified person in accordance with applicable codes.
- If the supply cord is damaged, it must be replaced by the manufacturer, its service agent or similarly qualified persons in order to avoid a hazard.
- Connect to potable water supply only.
- This appliance can be used by children aged 8 years and above and persons with reduced physical, sensory, or mental capabilities, or lack of experience and knowledge if they have been given supervision or instruction concerning use of the appliance in a safe way and understand the hazards involved. Children should be supervised to ensure that they do not play with the appliance.
- This appliance is intended to be used for household and similar applications such as staff kitchen areas in shops, offices and other working environments; farm houses and by clients in hotels, motels and other residential type environments; bed and breakfast type environments; catering and similar non-retail applications.
- **WARNING!** To avoid a hazard due to instability of the appliance, it must be fixed in accordance with the instructions.

Contents

Unpack	4
Unpack Ice Machine	4
Site Preparation	5
Installation site requirements	5
Louvered Docking Assembly Installation	6
External Connections	7
Ice Transport Tube Installation	7
Air-cooled ice machines only	8
Water-cooled ice machines only	8
Internal Connections	9
Ice transport tube	9
Potable water and drain lines	9
Power cord	9
Power cord	9
Cooling Lines	10
Ice transport tube	10
Potable Water and Drain Line	10
Cooling lines and power	10
Power cord	11
Power cord	11
Front Cover	12
Install cover	12
Start Up	12

1. Unpack

Carefully unpack and inspect the contents of your Follett ice machine.

1.1 Unpack Ice Machine

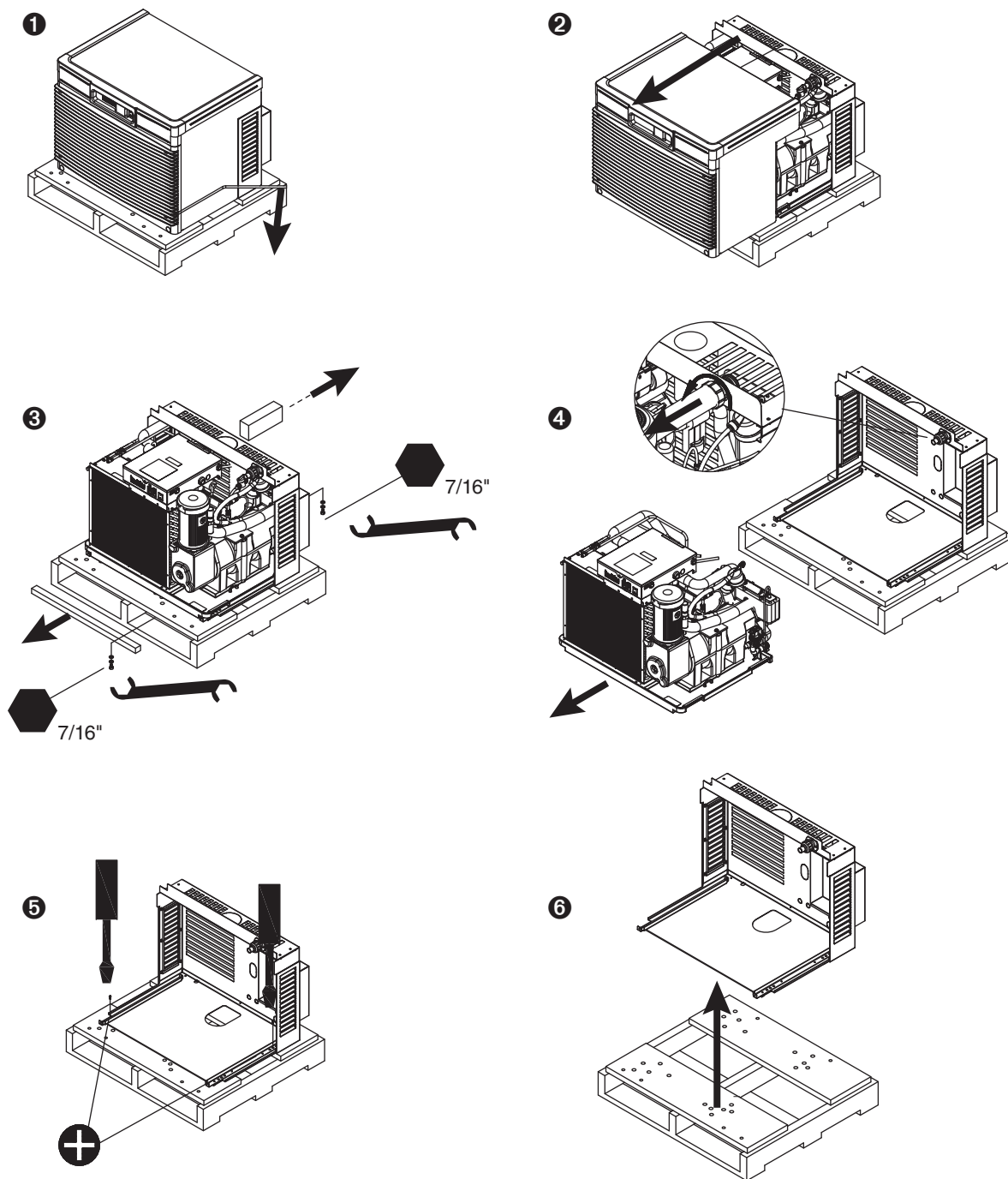

2. Site Preparation

Provide drainage, potable water supply and electrical power to within 6 feet (2m) of ice machine in accordance with local and national codes. Outdoor installation is not recommended and will void warranty.

2.1 Installation site requirements

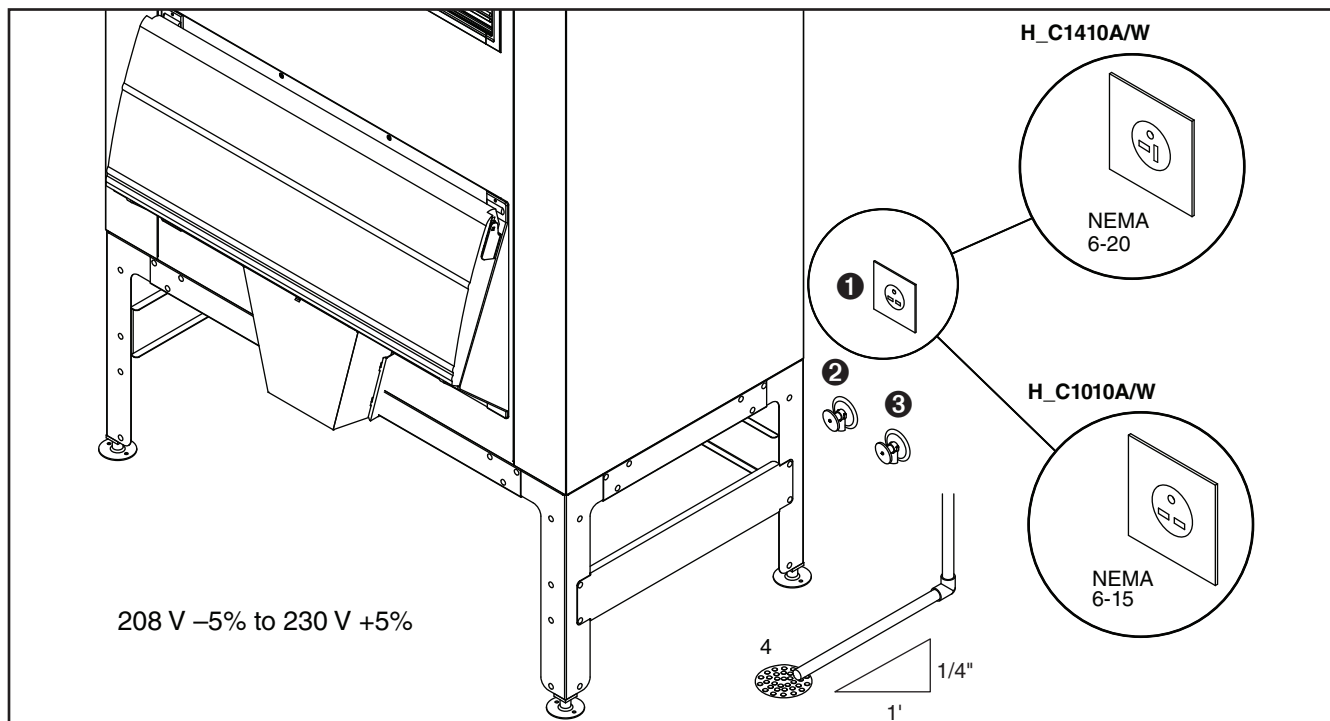

Electrical ❶



WARNING!

- This appliance should be permanently connected by a qualified person in accordance with applicable codes.
- If the supply cord is damaged, it must be replaced by the manufacturer, its service agent or similarly qualified persons in order to avoid a hazard.

H_C1010(A/W)BT 208-230/60/1-15A breaker*

* Requires a 15A dedicated circuit.

H_E1000(A/W)HS 230/50/1-15 amps‡

(H_E1000A/W requires 15A circuit, 1.50 mm² wire)

H_C1410(A/W)BT 208-230/60/1-20A breaker*

* Requires a 20A dedicated circuit.

H_E1400(A/W)HS 230/50/1-20 amps‡

(H_E1400A/W requires 20A circuit, 4.00 mm² wire)

‡ Plug must be provided by end user & must conform to standard EN 60 335-2-24 of the end destination.

Potable Water Supply ❷ (3/8" push-in internal connection, 3/8" OD tubing required)

10 psi to 70 psi (69 kpa to 483kpa)

45 F to 90 F (7 C to 32 C)

- This equipment is to be installed with adequate backflow protection to comply with applicable federal, state, and local codes

Condenser water supply for water-cooled systems ❸ (1/4" FPT inlet, 1/4" FPT outlet)

10 psi min.; 150 psi max. (69 kpa min.; 1034 kpa max.)

20 F to 90 F (-7 C to 32 C)

1.5 gallons (5.68 liters) per minute

Drain ❹ (3/4" MPT)

The drain line from the ice machine must have at least 1/4 in. per foot (6,4 mm/0,3 m) pitch

3. Louvered Docking Assembly Installation

WARNING!

- Docking station must be secured in accordance with these instructions to ensure ice machine stability.
- Ventilation openings in the louvered docking station should be clear of obstruction. Failure to do so could result in damage to equipment.
- Plug must be accessible after final installation.

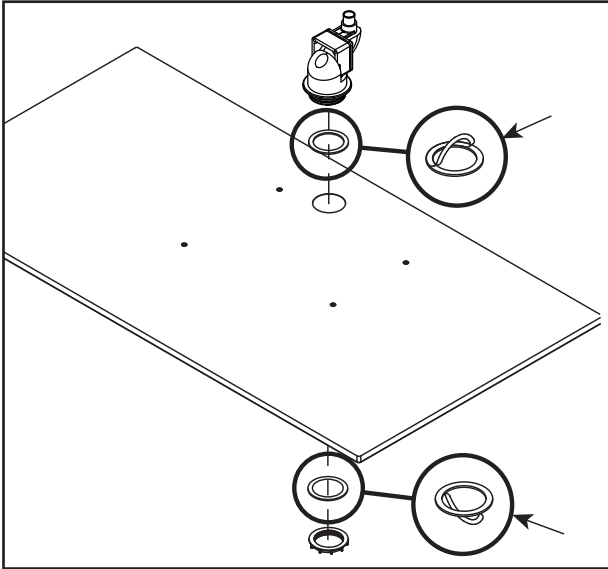

- Remove protective tape from gaskets.

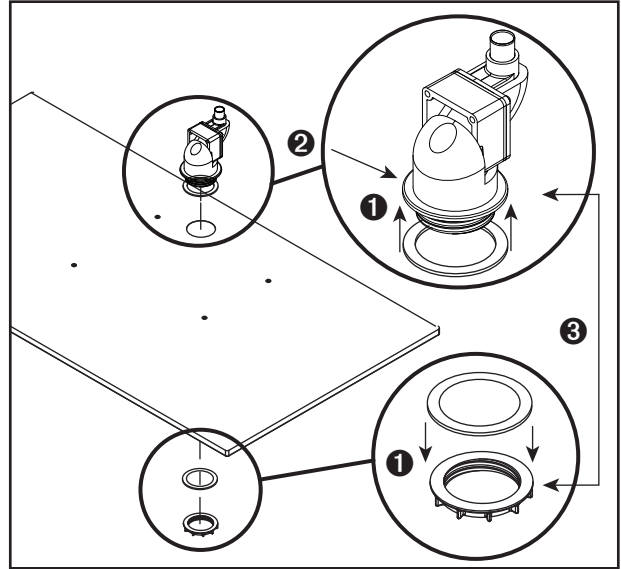

- Apply gaskets ①.
- Install shuttle actuator ② through dispenser top and secure with locking nut ③.

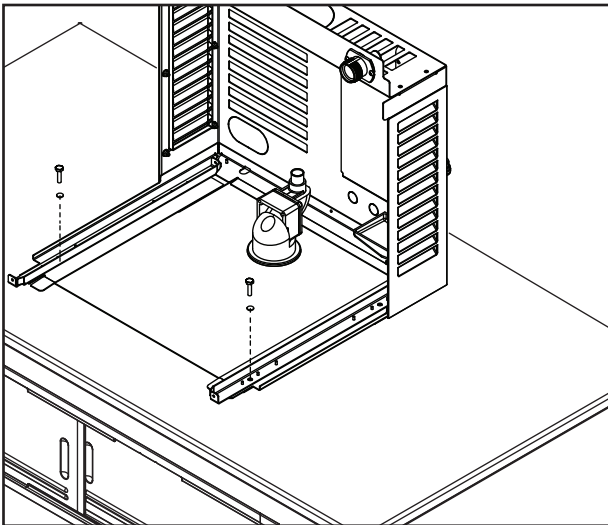

- Mount louvered docking assembly using two screws provided.

4. External Connections

4.1 Ice Transport Tube Installation

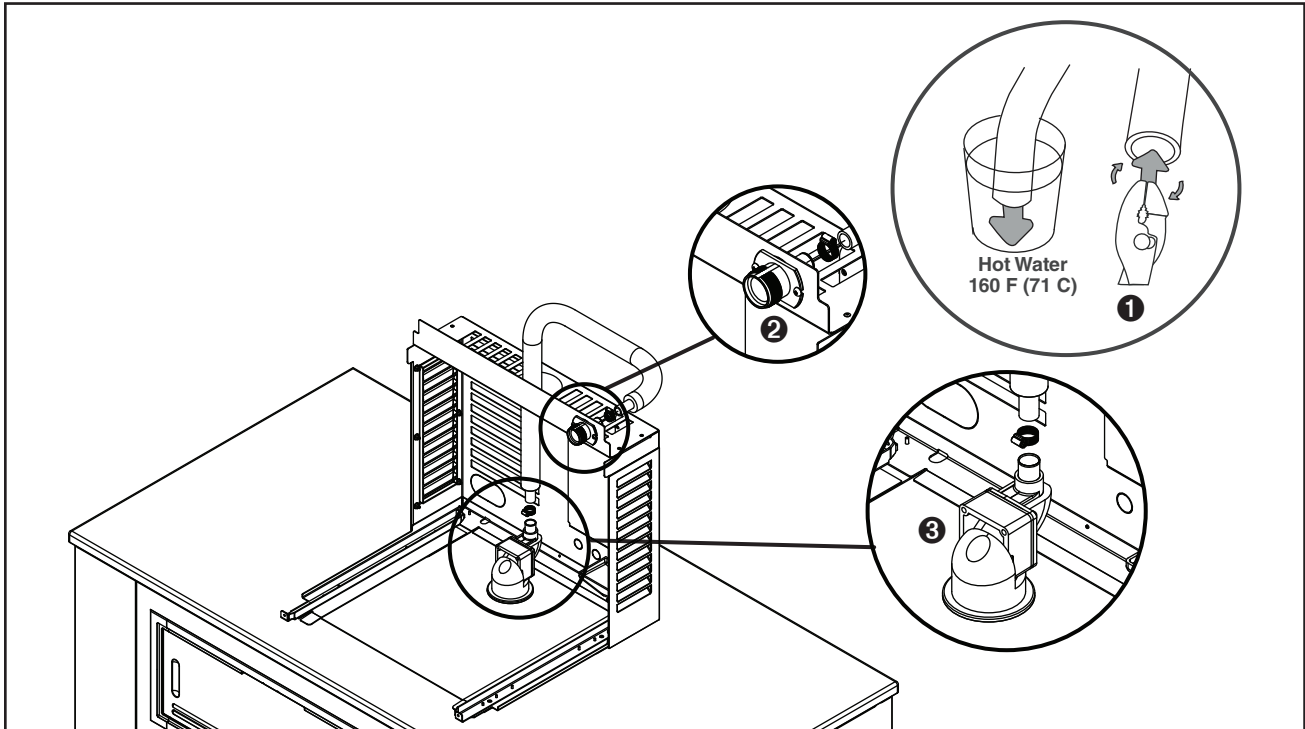

- Install supplied ice transport tube insulation.
- Heat end of transport tube in cup of 160 F (71 C) hot water to soften and spread with pliers ❶ before making connection to ease assembly.
- Connect ice transport tube to coupling on louvered docking station ❷.
- Connect ice transport tube to shuttle actuator ❸.

4.2 Air-cooled ice machines only

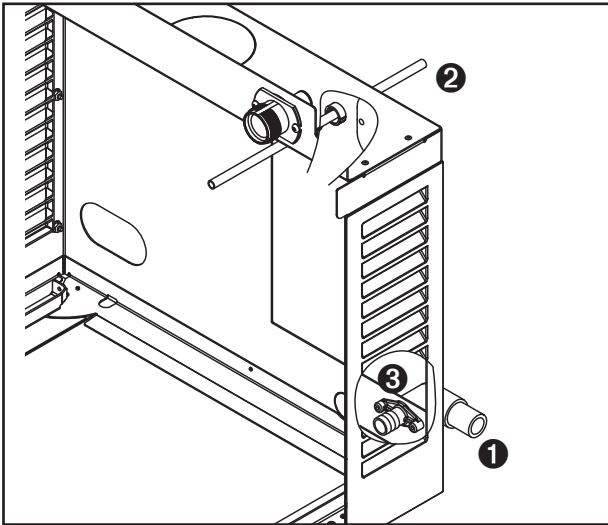

- Remove access panel if necessary
- Install drain line ①.
The rigid drain line from the ice machine must have at least 1/4" per foot (6,4 mm/0,3 m) pitch.
- Rough-in ice machine potable water supply ②.
3/8" push-in connection will be made at shut-off valve inside machine.
- Apply Petrogel to barbed drain fitting ③.
- Replace access panel.

4.3 Water-cooled ice machines only

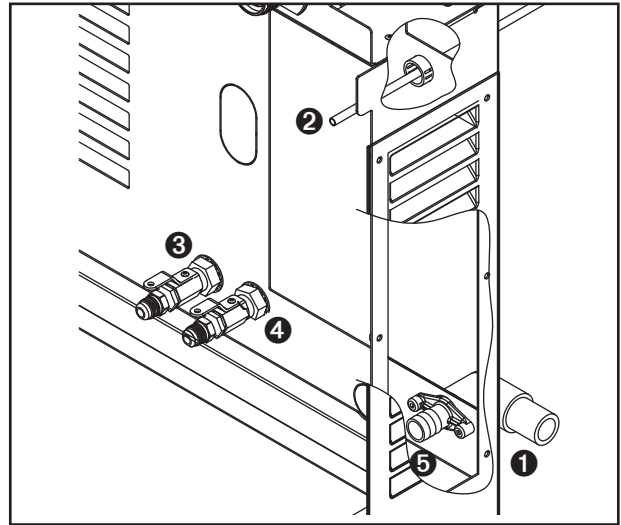

- Remove access panel if necessary
- Install drain line ①.
The rigid drain line from the ice machine must have at least 1/4" per foot (6,4mm/0,3m) pitch.
- Rough-in ice machine potable water supply ②.
3/8" push-in connection will be made at shut-off valve inside machine.
- Connect cooling water supply ③ and return ④.
- Apply Petrogel to barbed drain fitting ⑤.
- Replace access panel.

5. Internal Connections

Air-cooled ice machines – follow steps 5.1 and 5.5.

Water-cooled ice machines – follow steps 5.6 through 5.12.

5.1 Ice transport tube

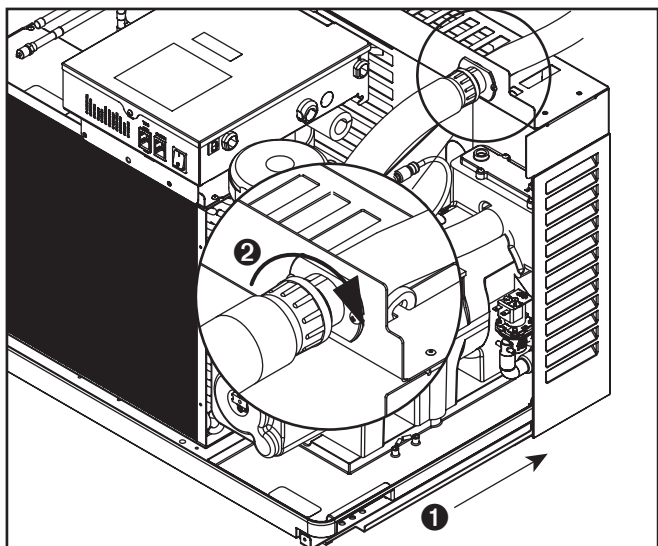

- Slide ice machine into louvered docking assembly *ensuring that drain tube is fully seated on barbed drain fitting 1*.
- Insert ice transport tube all the way into coupling and tighten nut firmly 2.

5.2 Potable water lines

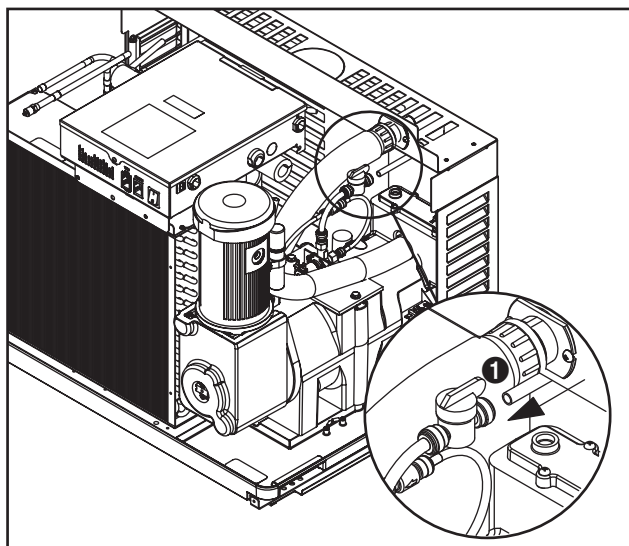

- Insert potable water line into valve 1.

5.3 Power cord

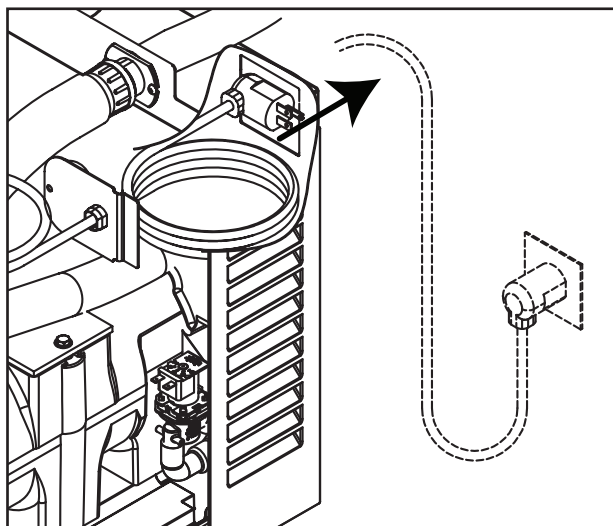

- Remove twist tie.
- Carefully pass plug thru opening and plug into wall outlet.
- For H_E units, install a suitable plug.

5.4 Power cord

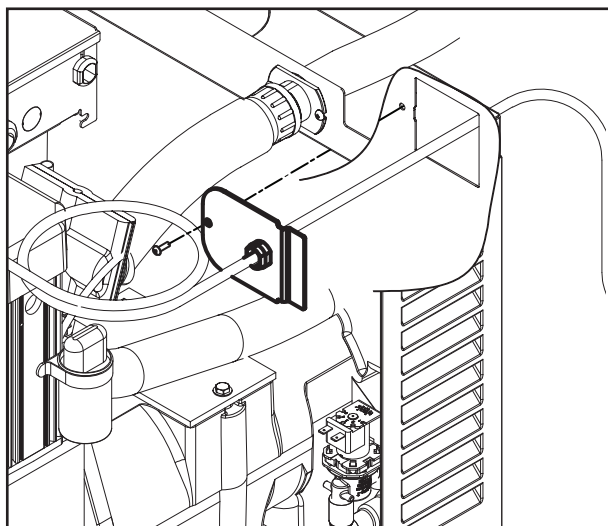

- Position plate into opening and secure with supplied screw.



WARNING!

Plate must be securely installed to ensure proper equipment ground.

5.5 TDS switch

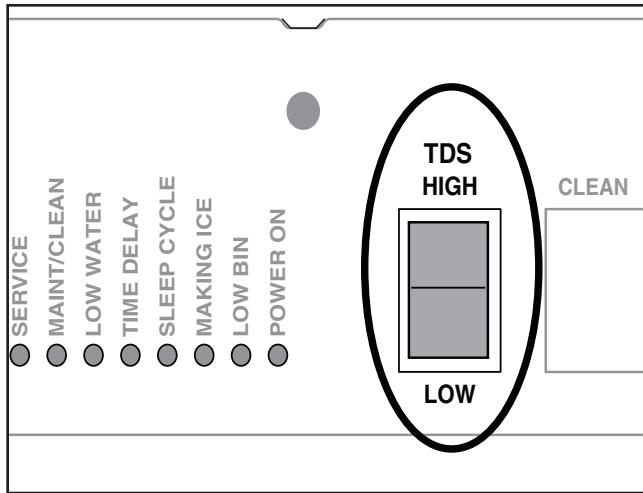

- Set the TDS switch on the electrical box.
 - **HIGH:** for extended service life
 - **LOW:** for low-scale water

5.6 Cooling Lines

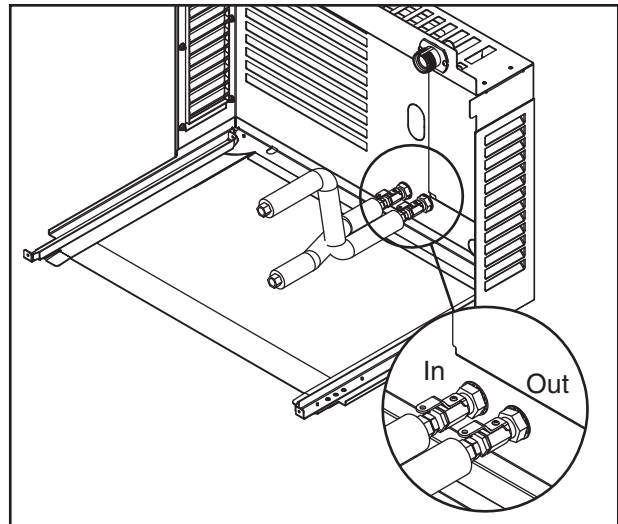

- Install ice machine cooling water lines to louvered docking assembly.

5.7 Ice transport tube

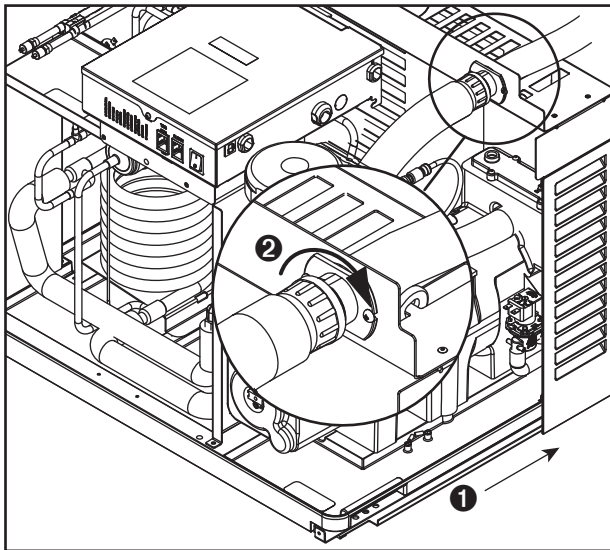

- Slide ice machine into louvered docking assembly *ensuring that drain tube is fully seated on barbed drain fitting ①*.
- Insert ice transport tube into coupling and tighten nut firmly ②.

5.8 Potable Water Line

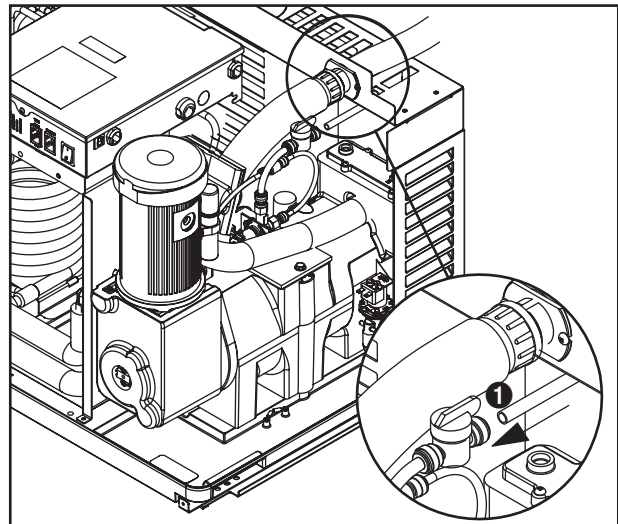

- Insert potable water line into valve ①.

5.9 Cooling lines and power

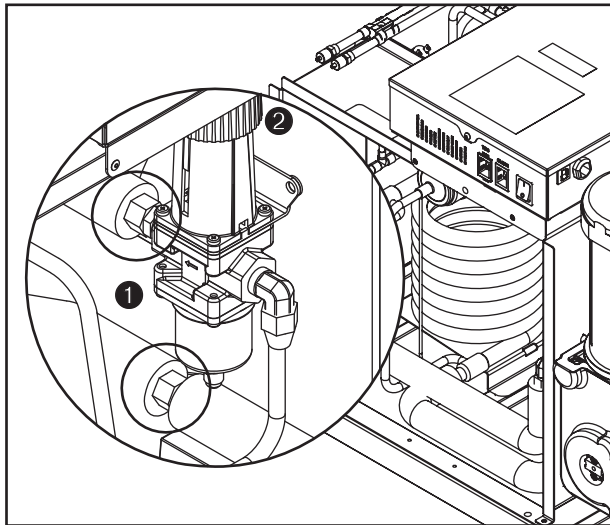

- Connect cooling water lines to ice machine ①. (Water "Out" connects to water regulator.)
- Water valve is set at the factory. **DO NOT** remove seal or adjust water valve ②.

5.11 Plate

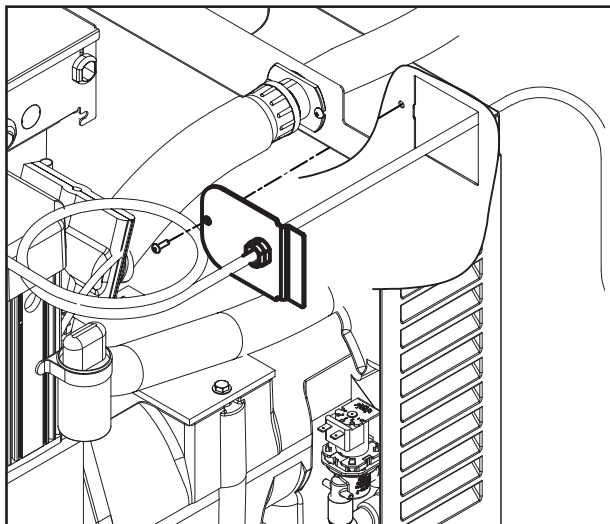

- Position plate into opening and secure with supplied screw.

WARNING!

Plate must be securely installed to ensure proper equipment ground.

5.10 Power cord

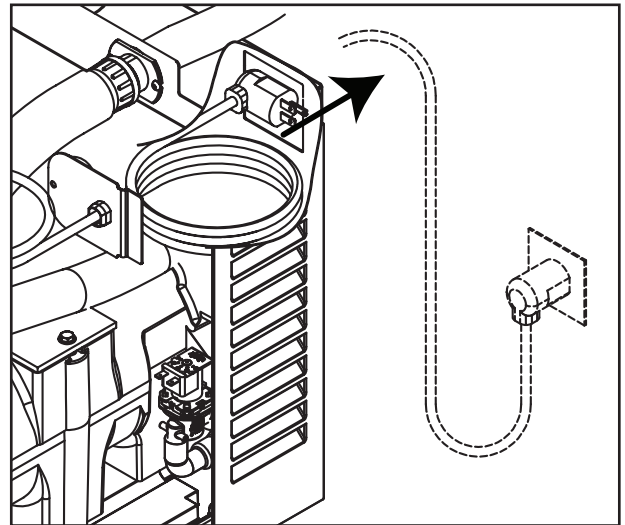

- Remove twist tie.
- Carefully pass plug thru opening and plug into wall outlet.
- For H_E units, install a suitable plug.

5.12 TDS switch

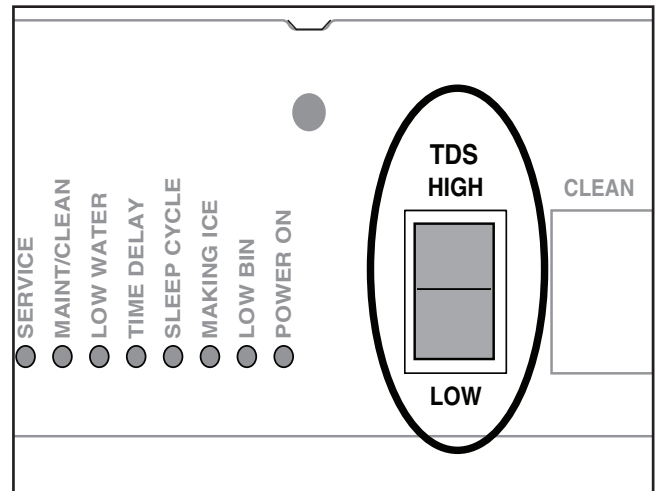

- Set the TDS switch on the electrical box.
 - **HIGH:** for extended service life
 - **LOW:** for low-scale water

6. Front Cover

Install front cover to ice machine.

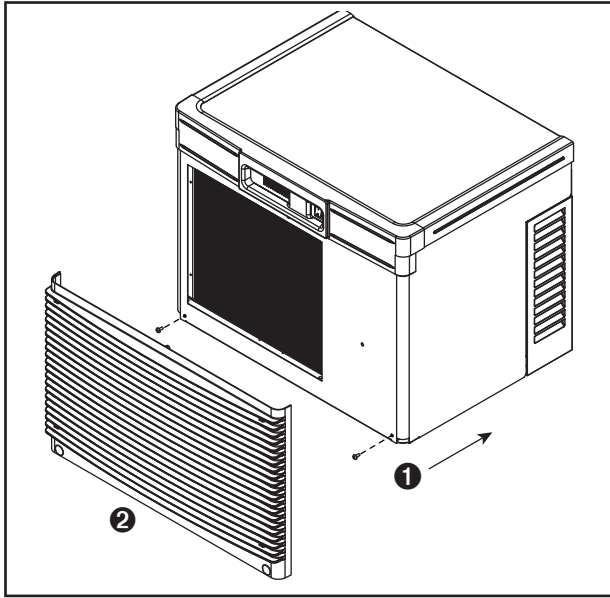

- Slide ice machine cover over machine, ensuring that tabs on back of cover slip under louvers on back of louvered docking assembly ①, then tighten two screws through cover.
- Place louvered front cover on machine ②.

7. Ice machine start up procedure

The start-up procedure below is intended to ensure that ice machine is operating properly after installation has been made. Check each item listed and call factory immediately for assistance if you experience problems with unit.

NOTICE!

- Ice machine **MUST** be sanitized prior to operation!
- Consult Operation and Service Manual provided with ice machine for sanitizing instructions.

7.1 Before turning on power

1. Sanitize ice bin.
2. Turn on water to ice machine and check for leaks.

7.2 After turning on power

1. Turn on power switch and immediately press Clean switch to sanitize ice machine. At beginning of sanitizing process, ice machine will purge all water. Check internal and external drain connections for leaks.
2. After sanitizing process, ice machine will start. Confirm that gearmotor, fan motor and compressor start immediately.
3. Check that ice begins to enter dispenser bin area within approximately 10 minutes.

Horizon, Horizon Elite, and Harmony are trademarks of Follett Corporation.

Follett, Chewblet and RIDE are registered trademarks of Follett Corporation, registered in the US.