

Horizon Elite™ Ice Machine Installation Instructions for Harmony™ Top-mount Applications

HCC1010AHT, HCC1410AHT, HCC1010WHT, HCC1410WHT,
HMC1010AHT, HMC1410AHT, HMC1010WHT, HMC1410WHT,
HCE1010AHT, HCE1410AHT, HCE1010WHT, HCE1410WHT,
HME1010AHT, HME1410AHT, HME1010WHT, HME1410WHT
(See model number configurator on page 2 for details.)

Order parts online
www.follettice.com

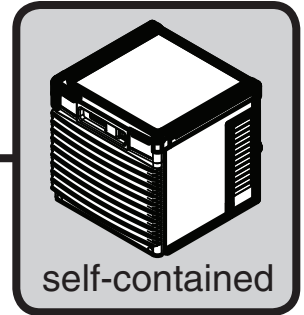

**Horizon top-mount ice machines
fit most countertop dispensers manufactured by
Cornelius • Lancer • SerVend**

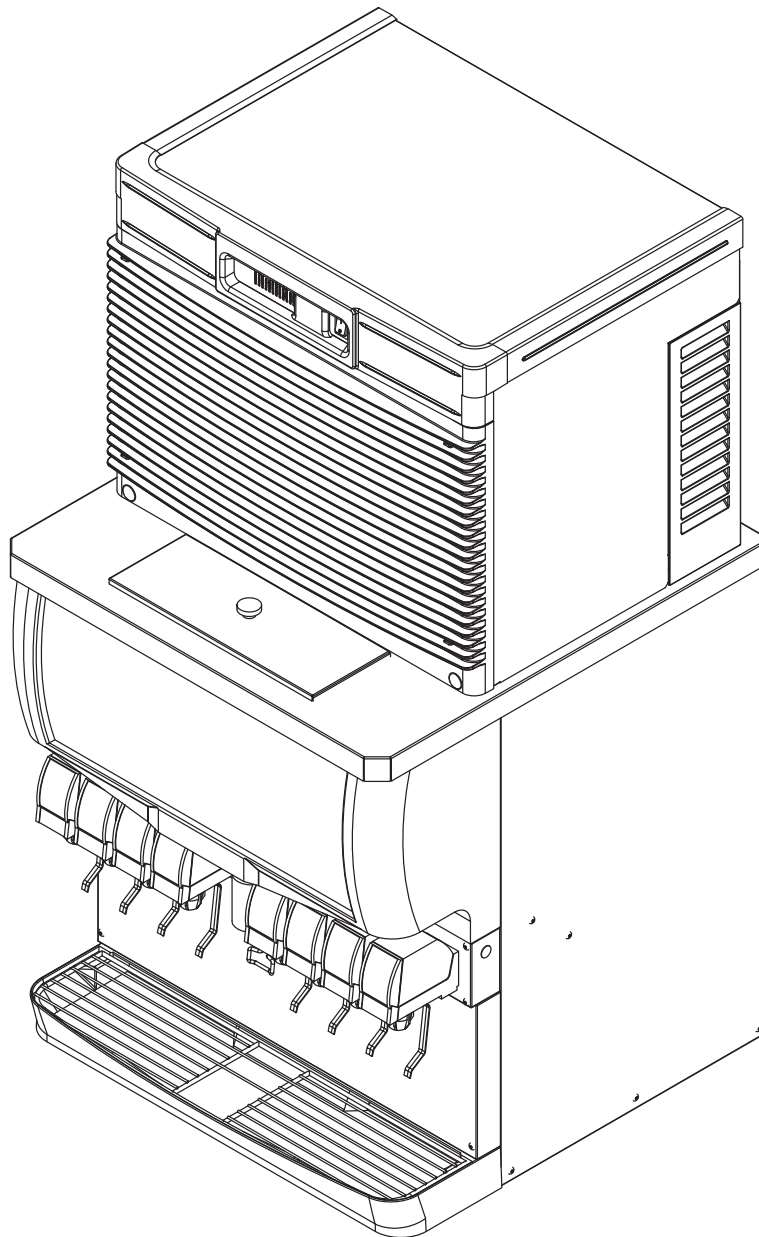

Chewblet® Ice Machine Model Number Configurations

<div style="display: flex; justify-content: space-around; align-items: center;"> <div style="border: 1px solid black; padding: 2px 5px;">HC</div> <div style="border: 1px solid black; padding: 2px 5px;">C</div> <div style="border: 1px solid black; padding: 2px 5px;">1400</div> <div style="border: 1px solid black; padding: 2px 5px;">A</div> <div style="border: 1px solid black; padding: 2px 5px;">V</div> <div style="border: 1px solid black; padding: 2px 5px;">S</div> </div>					
Icemaker	Voltage	Series	Condenser	Application	Configuration
MC Maestro™ Chewblet® (400 Series)	C 208-230/60/1 (icemaking head) <i>Self-contained only.</i> D 115/60/1 (icemaking head) <i>Self-contained and remote. If remote unit, high side is 208-230/60/1.</i>	400 up to 454 lbs (206kg)	A Air-cooled, self-contained W Water-cooled, self-contained R Air-cooled, remote condensing unit N Air-cooled, no condensing unit for connection to parallel rack system	V Vision™ H Harmony™ B Ice storage bin J Drop-in M Ice Manager diverter valve system	S RIDE™ <i>(RIDE remote ice delivery equipment)</i> T Top-mount
HC Horizon Chewblet (1000, 1400, 1650 Series)	E 230/50/1 (icemaking head) <i>Self-contained only.</i> F 115/60/1 (icemaking head) <i>Remote only. High side is 208-230/60/3.</i>	1000/1010 up to 1036 lbs (471kg) 1400/1410 up to 1450 lbs (658kg) 1650 up to 1580 lbs (717kg)			
HM Horizon Micro Chewblet					

CAUTION!

- This appliance should be connected by a qualified person in accordance with applicable codes.
- If the supply cord is damaged, it must be replaced by the manufacturer, its service agent or similarly qualified persons in order to avoid a hazard.
- Connect to potable water supply only.
- This appliance can be used by children aged 8 years and above and persons with reduced physical, sensory, or mental capabilities, or lack of experience and knowledge if they have been given supervision or instruction concerning use of the appliance in a safe way and understand the hazards involved. Children should be supervised to ensure that they do not play with the appliance.
- This appliance is intended to be used for household and similar applications such as staff kitchen areas in shops, offices and other working environments; farm houses and by clients in hotels, motels and other residential type environments; bed and breakfast type environments; catering and similar non-retail applications.
- **WARNING!** To avoid a hazard due to instability of the appliance, it must be fixed in accordance with the instructions.

Read and complete the following 8 installation steps

1 **Unpack** _____



2 **Site preparation** _____



3 **Bin preparation** _____

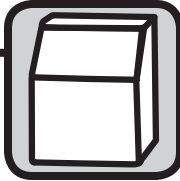

4 **Louvered docking assembly** _____

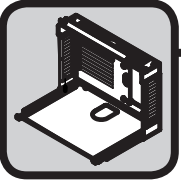

5 **Ice transport tube** _____



6 **External connection** _____



7 **Internal connection** _____

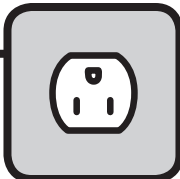

8 **Front cover** _____

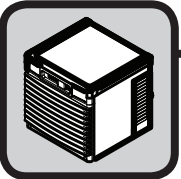

Carefully unpack and inspect the contents of your Follett ice machine.

Unpack

1



1.1 Unpack ice machine

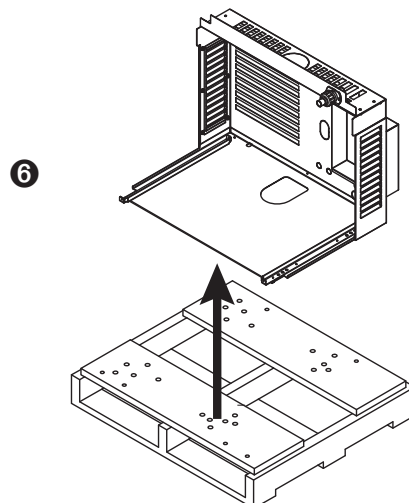
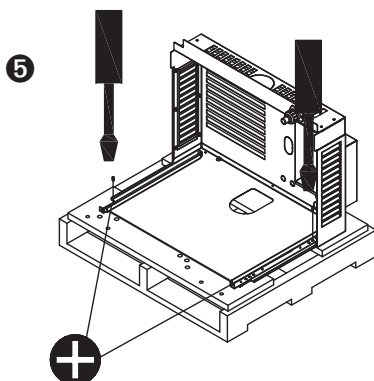
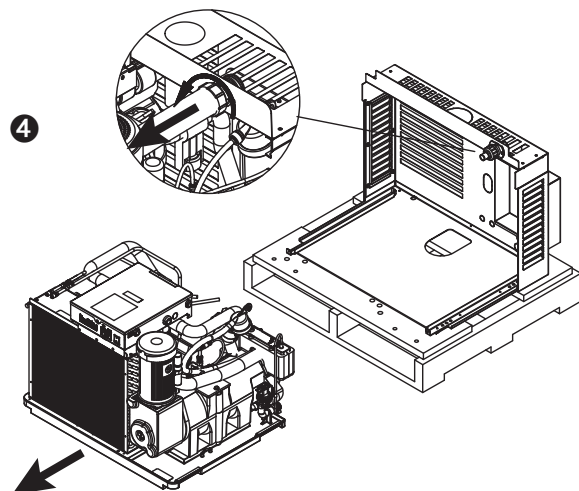
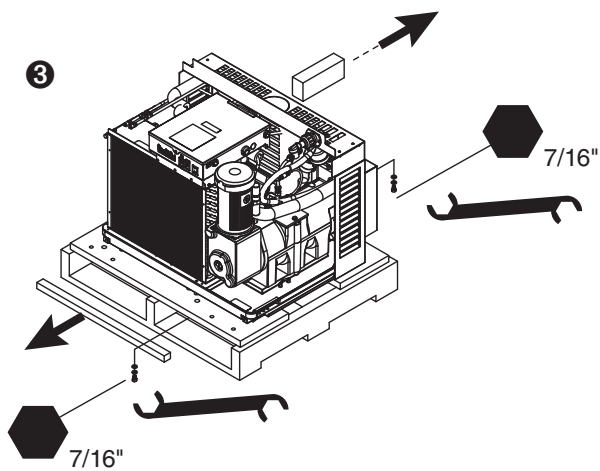
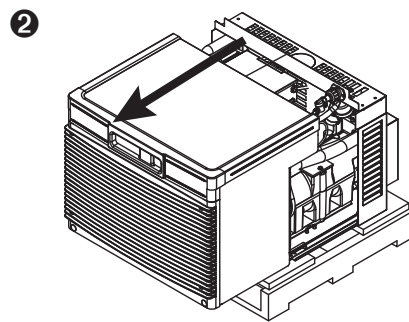
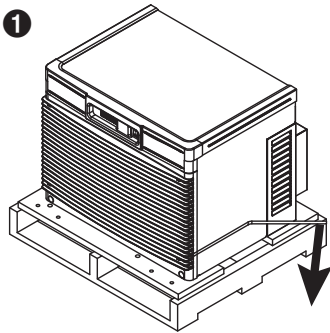

Prepare the installation site.

Provide drainage, water supply and electrical power to within 6 feet (2m) of ice machine in accordance with local and national codes. Outdoor installation is not recommended and will void warranty.

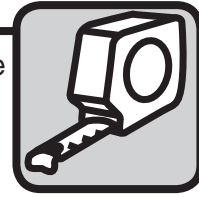

2.1 Installation site requirements

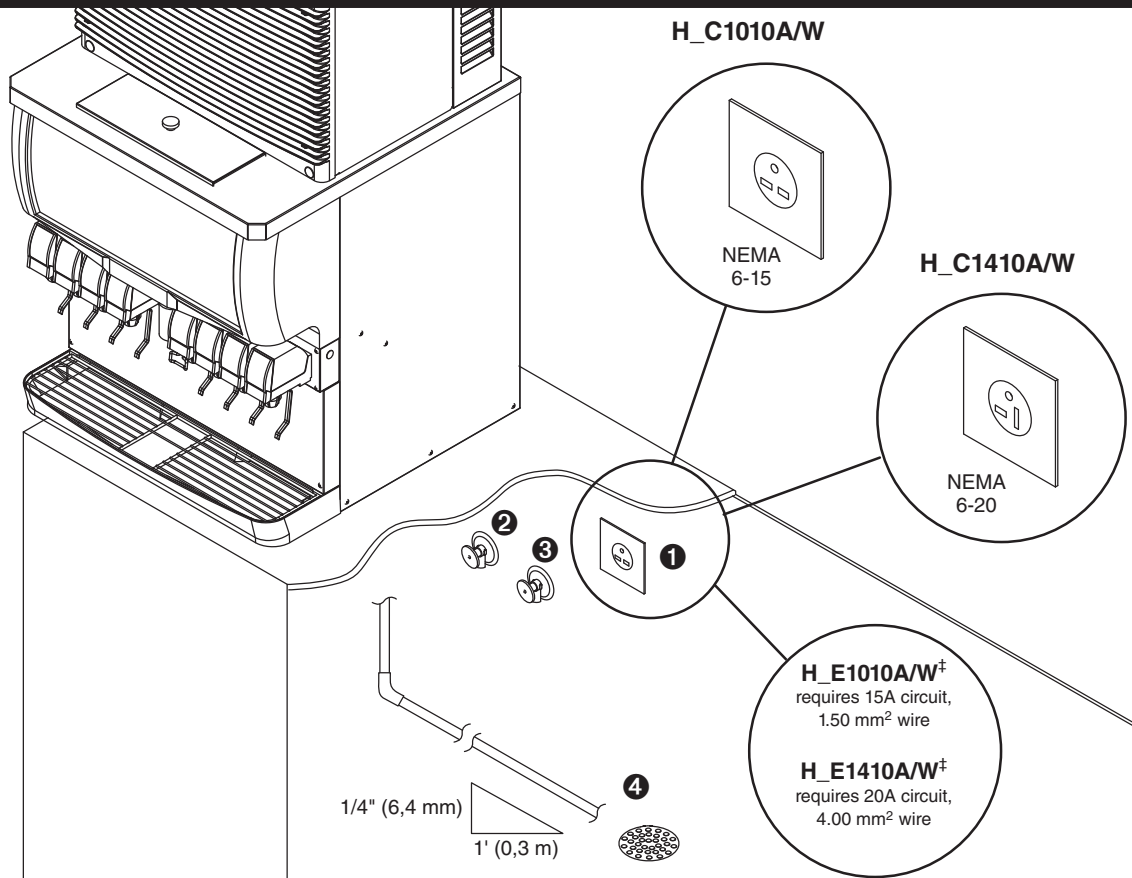

Electrical ①

- H_C1010(A/W)JS 208-230/60/1-15 amps
- H_E1010(A/W)JS 230/50/1-15 amps[‡]
(H_E1010A/W Requires 15 amp circuit 1.50 mm² wire)
- H_C1410(A/W)JS 208-230/60/1-20 amps
- H_E1410(A/W)JS 230/50/1-20 amps[‡]
(H_E1410A/W Requires 20 amp circuit 4.00 mm² wire)

[‡] Plug must be provided by end user & must conform to standard EN 60 335-2-24 of the end destination.

Potable water supply ② (3/8" push-in internal connection, 3/8" OD tubing required)

- 10-70 psi (69-483kpa)
- 45 to 90 F (7 to 32 C)
- Follett recommends the use of an in-line water filtration system (item# 00130286)
- This equipment is to be installed with adequate backflow protection to comply with applicable federal, state, and local codes

Condenser water supply for water-cooled systems ③ (1/4" FPT inlet, 1/4" FPT outlet)

- 10 psi min.; 150 psi max. (69kpa min.; 1034kpa max.)
- 45 to 90 F (7 to 32 C)
- 1.5 gallons per minute (5.68 liters per minute)

Drain ④ (3/4" MPT)

- The drain line from the ice machine must have at least 1/4" per foot pitch (6,4mm/0,3m)

Prepare the dispenser.

Dispenser preparation

3

Note: The instructions below only apply to 22" & 30" wide dispensers.
44" wide dispenser instructions may be found with the top kit.



3.1 Top preparation – ALL

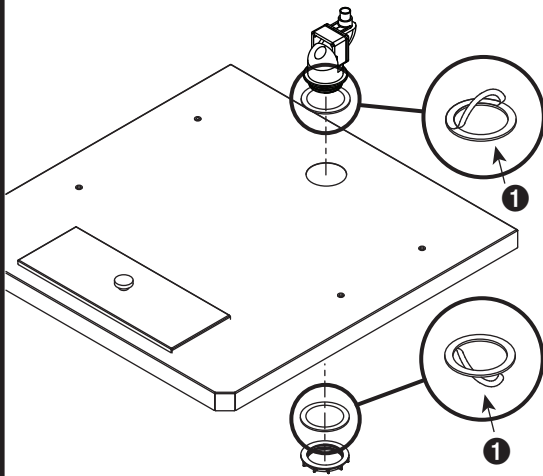

All models

- Remove protective tape from gaskets ①

3.2 Top preparation – ALL

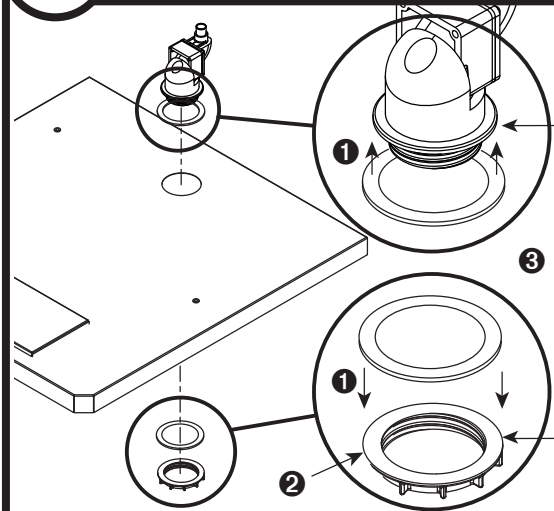

- Apply gaskets ①.
- Install coupling ② through bottom of dispenser top and secure with locking nut ③

3.3 Top preparation – ALL

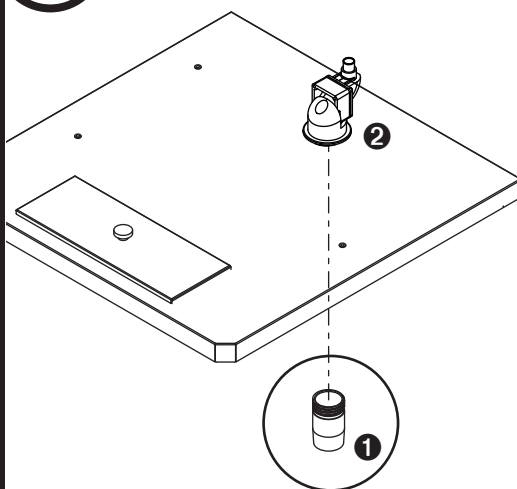

- Screw 4" (102mm) extension ① into bottom of shuttle actuator ②

3.4 Top preparation – CORNELIUS

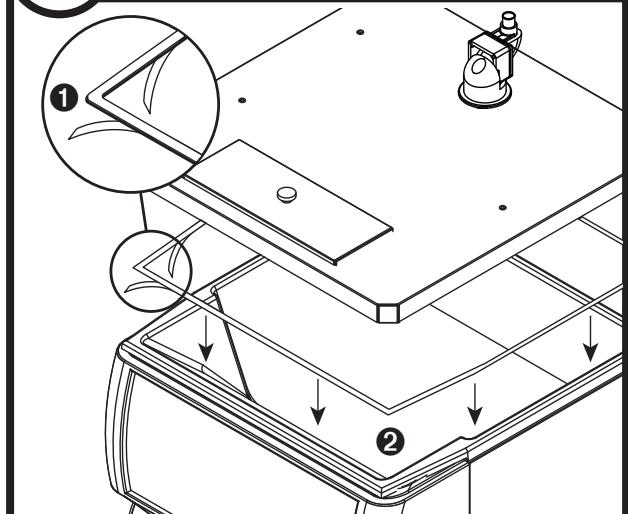

Cornelius models only

- Remove protective tape ①
- Apply gasket ②

3.5 Top preparation – LANCER

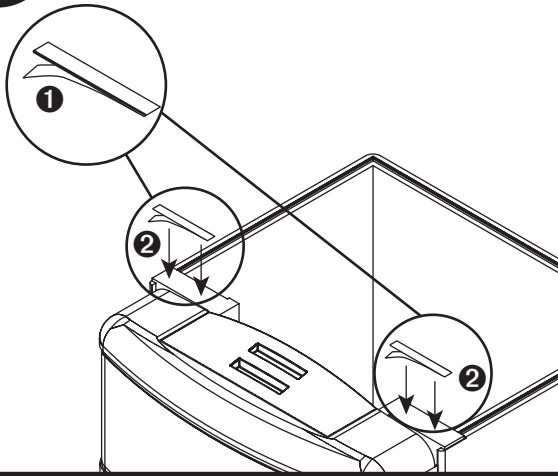

Lancer models only

- Remove protective tape ①
- Apply gaskets ②

3.6 Agitation adjust. – CORNELIUS

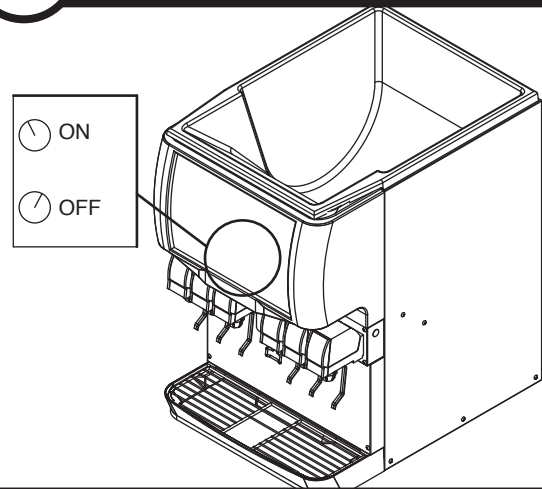

Cornelius models ED, DB, DF, IDC and FLAVOR FUSION

Adjust the agitation timer located on the Cornelius PC board to 1 second on, 1 hour off. **Note:** See Cornelius manual for more information.

3.7 Agitation adjustments – LANCER 4500 SERIES

PRESS IN ON THIS SIDE TO TURN SWITCH OFF.

ROCKER SWITCHES (VIEW LOOKING DOWN)

PRESS IN ON THIS SIDE TO TURN SWITCH ON.

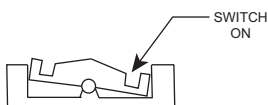
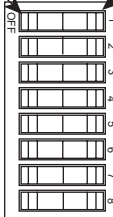

SWITCH OFF

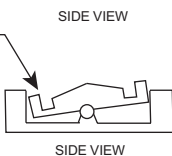

SWITCH NUMBER	AGITATION TIME			
	1 SECOND	2 SECONDS	3 SECONDS	4 SECONDS
3	O	O	X	X
4	O	X	O	X

X = ON
O = OFF

SWITCH NUMBER	AGITATION FREQUENCY														
	NO AGITATION	10 MINUTES	20 MINUTES	30 MINUTES	40 MINUTES	50 MINUTES	60 MINUTES	70 MINUTES	80 MINUTES	90 MINUTES	100 MINUTES	110 MINUTES	120 MINUTES	130 MINUTES	140 MINUTES
5	O	O	O	O	O	O	O	X	X	X	X	X	X	X	X
6	O	O	O	O	X	X	X	X	O	O	O	O	X	X	X
7	O	O	X	X	O	O	X	X	O	O	X	X	O	O	X
8	O	X	O	X	O	X	O	X	O	X	O	X	O	X	X

Lancer 4500 series only

Adjust the agitation time to 1 second, and the agitation frequency to 150 minutes. See Lancer manual for more information.

3.8 Agitation adjustments – LANCER Sensation and Touchpoint

No agitation adjustment required

3.9 Agitation adjustments – LANCER FS SERIES

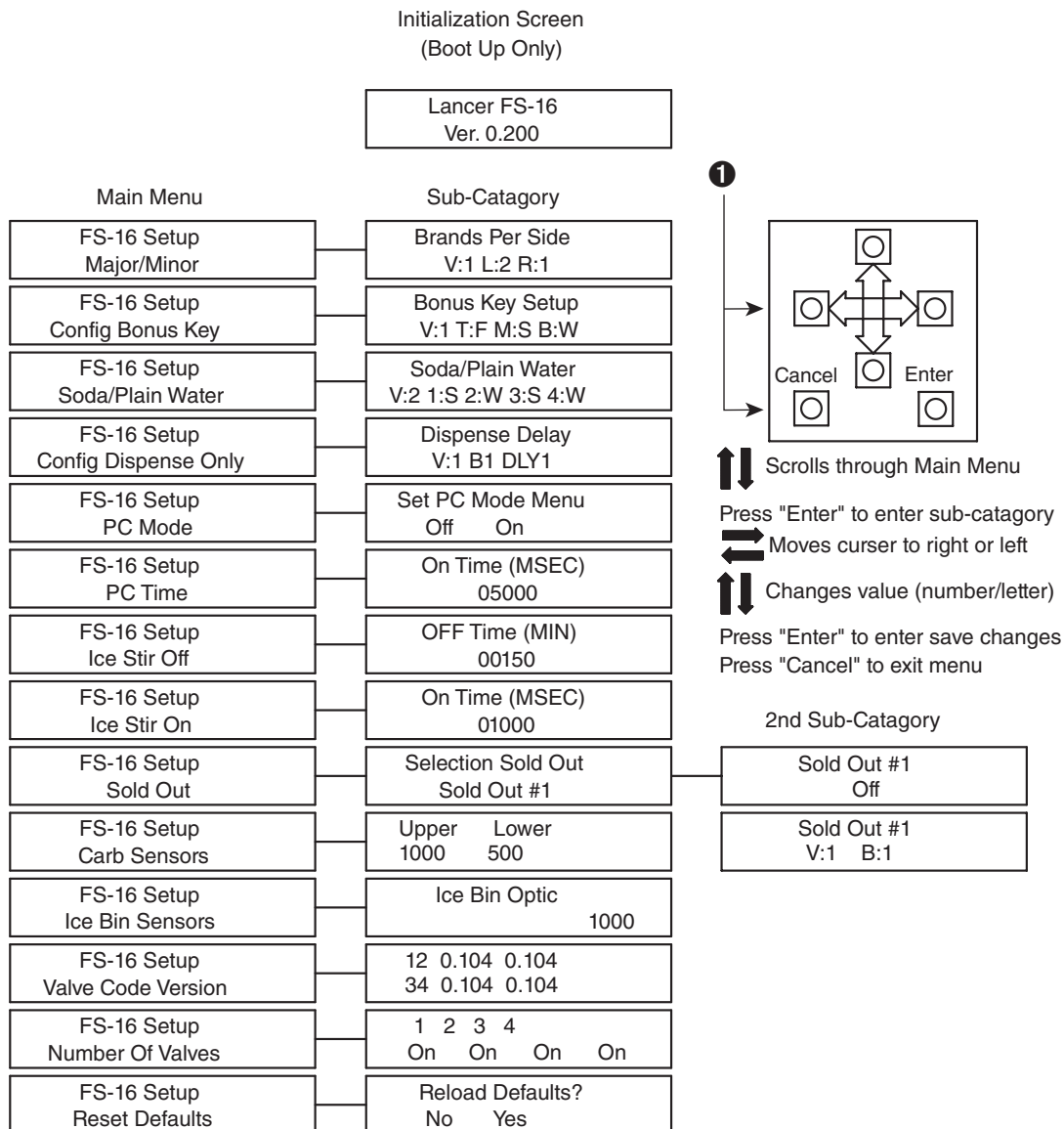

Lancer FS series only

- Hold down "cancel" and "left button" to get to hidden menu **1**
- Type in code 6655
- Type in 150 minutes of off time and 1010 milliseconds (1 second of time) as the preferred setting

Note: See Lancer manual for more information

3.10 Agitation adjustments – SERVEND

SerVend models only

No agitation adjustment required.

3.11

Dispenser diverter plate overview (Installation on next page)

Single Agitator

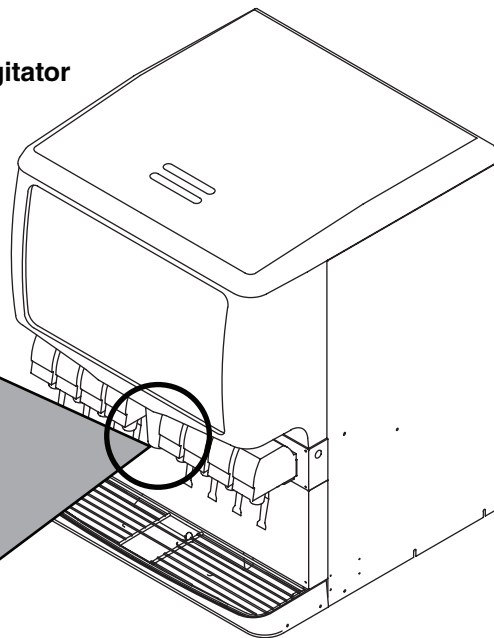
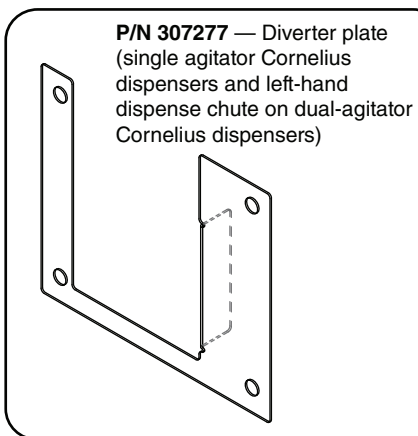

Dual Agitator

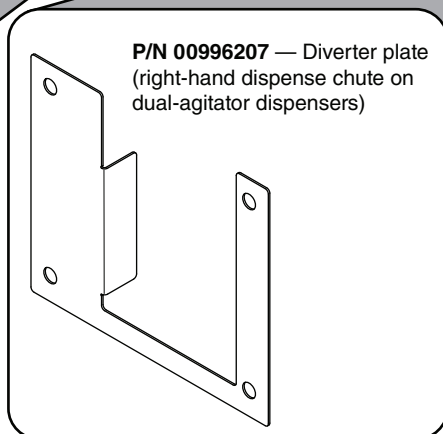
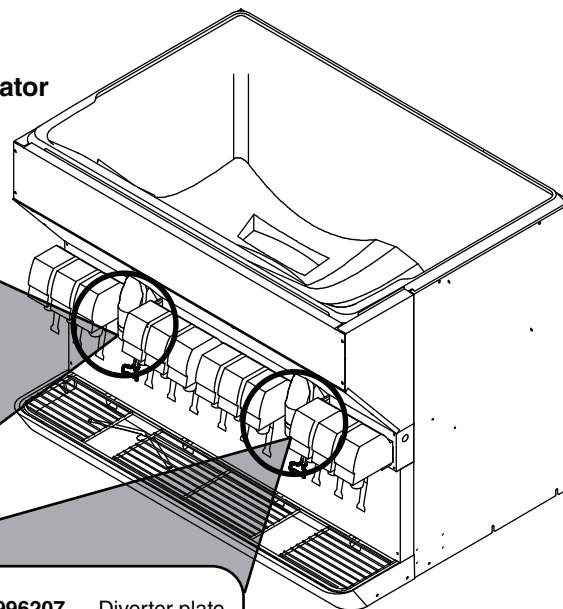
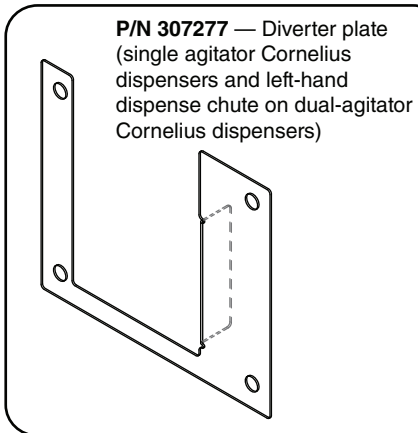

3.12

Dispenser diverter plate installation – CORNELIUS ED, DF and DB SERIES

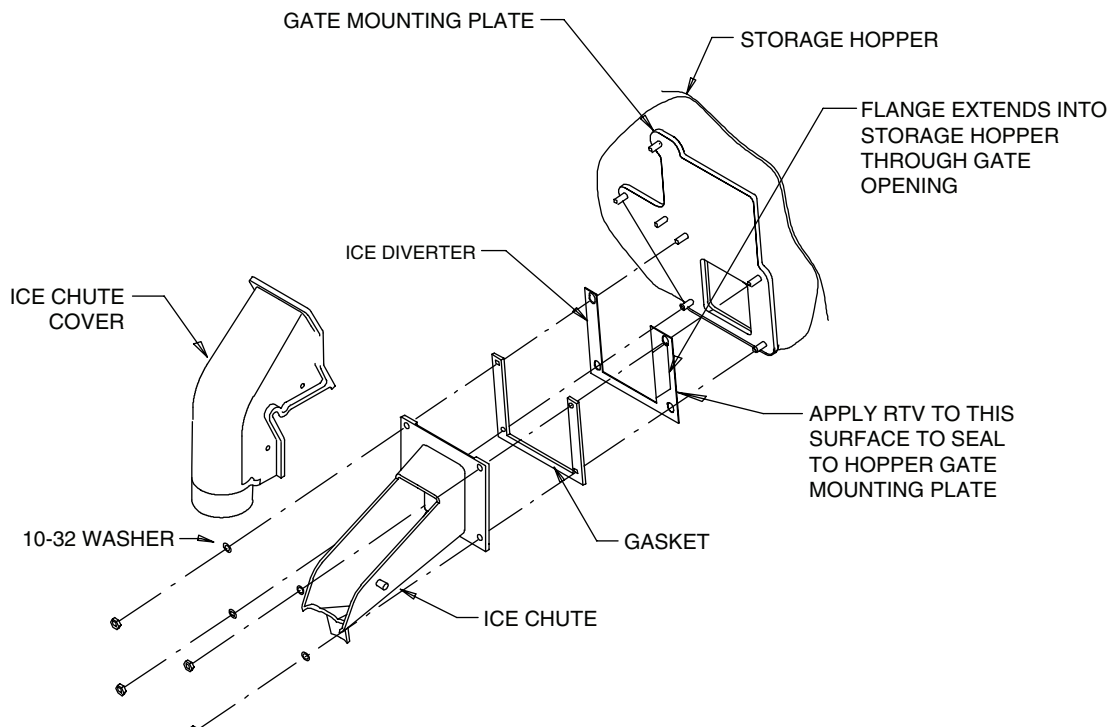

Cornelius ED, DF and DB series only

These dispensers require the installation of an ice diverter at the dispenser opening.

- Disassemble chute assembly
- Discard factory restrictor plate
- Replace with alternate diverter plate (supplied)

3.13

Agitation adjustments – Cornelius IDC and Flavor Fusion

These dispensers require modifications for compatibility with Chewblet ice. Agitation times must be set to 1 second ON, 1 hour OFF and the ice restrictor plate must be adjusted to the fully open position. See your beverage supplier for these modifications.

Install the louvered docking assembly.



WARNING

- Docking station must be secured in accordance with these instructions to ensure ice machine stability.
- Ventilation openings in the louvered docking station should be clear of obstruction

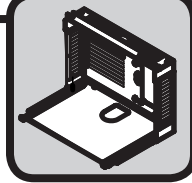

4.1 Louvered docking assembly

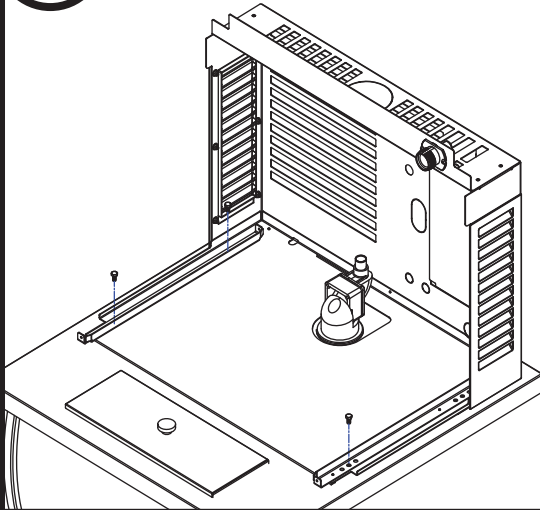

- Mount louvered docking assembly

Install the ice transport tube.

Ice transport tube

5



5.1 Ice transport tube installation

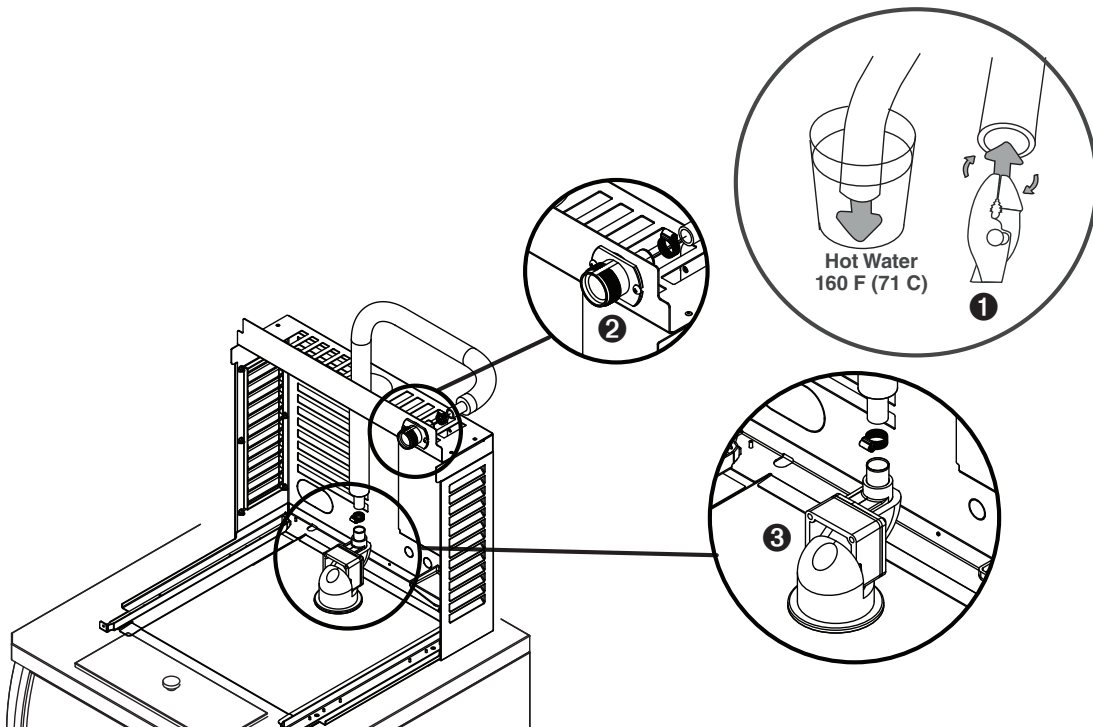

- Install supplied ice transport tube insulation
- Heat end of transport tube in cup of 160 F (71 C) hot water to soften and spread with pliers ❶
- Connect ice transport tube to coupling on louvered docking station ❷
- Connect ice transport tube to shuttle actuator ❸

Connect utilities to louvered docking assembly.



6.1 Air-cooled ice machines only

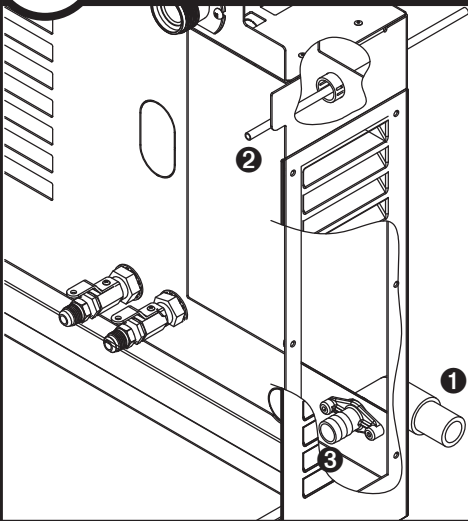

- Remove access panel if necessary
- Install drain line ①.
The rigid drain line from the ice machine must have at least 1/4" per foot pitch (6,4mm/0,3m).
- Rough-in ice machine potable water supply ②.
3/8" push-in connection will be made at shut-off valve inside machine.
- Apply Petrogel to barbed drain fitting ③
- Replace access panel

6.2 Water-cooled ice machines only

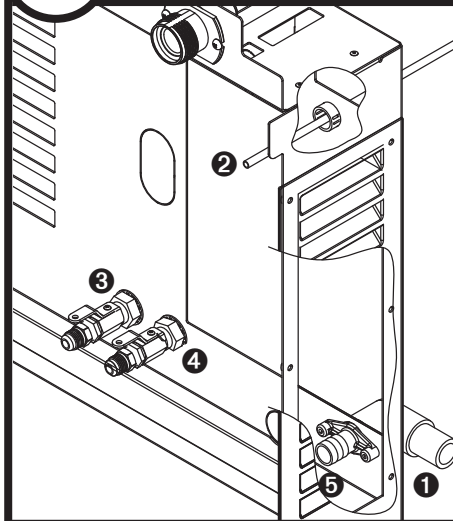

- Remove access panel if necessary
- Install drain line ①.
The rigid drain line from the ice machine must have at least 1/4" per foot pitch.
- Rough-in ice machine potable water supply ②.
3/8" push-in connection will be made at shut-off valve inside machine.
- Connect cooling water supply ③ and return ④
- Apply Petrogel to barbed drain fitting ⑤
- Replace access panel

Connect louvered docking assembly to ice machine.

Internal connections

7



CAUTION

- Plug must be accessible after final installation.
- H_E1410A/W 230/50/1 requires a 20A circuit (4.00 mm² wire)



Air-cooled ice machines – follow steps 7.1 through 7.5.

7.1 Ice transport tube

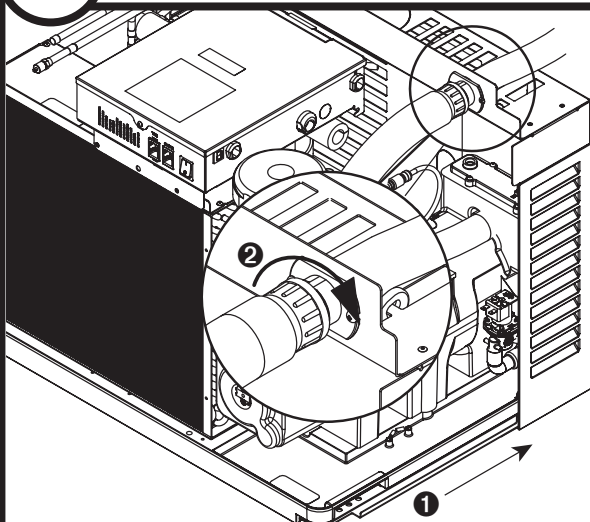

- Slide ice machine into louvered docking assembly *ensuring that drain tube is fully seated on barbed drain fitting* ①
- Insert ice transport tube all the way into coupling and tighten nut firmly ②

7.2 Potable water and drain lines

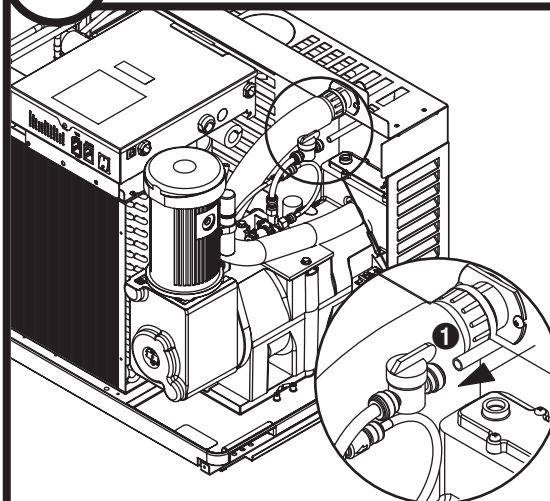

- Insert potable water line into valve ①

7.3 Power cord

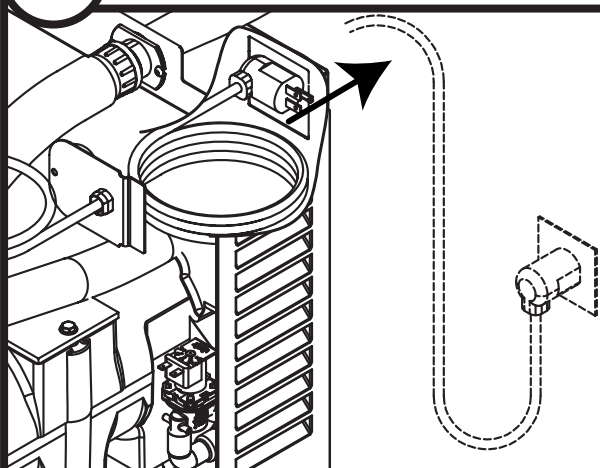

- Remove twist tie
- Carefully pass cord thru opening and plug into wall outlet
- For H_E units, install a suitable plug

7.4 Power cord

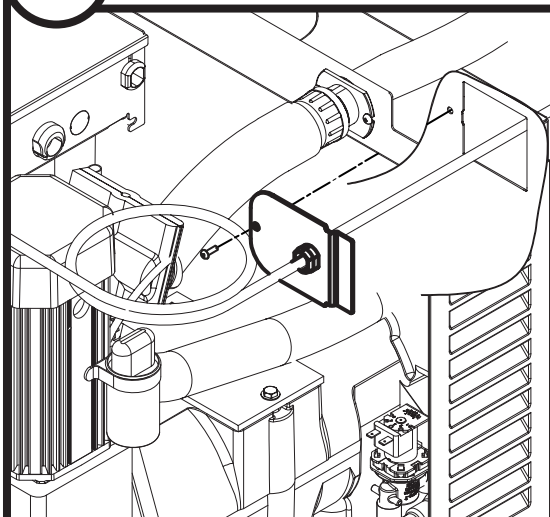

- Position plate into opening and secure with supplied screw

Water-cooled ice machines – follow steps 7.6 through 7.12.

7.5 TDS switch

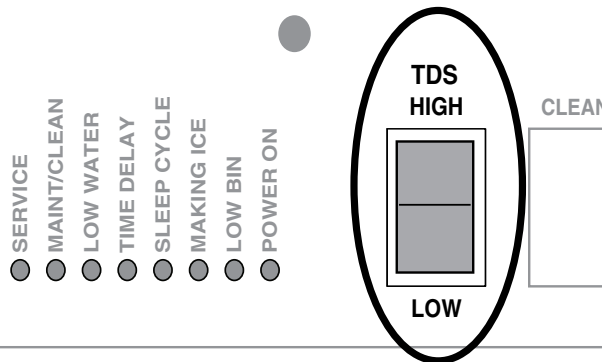

- Set the TDS switch on the electrical box:
HIGH: for extended service life
LOW: for low-scale water

7.6 Cooling lines

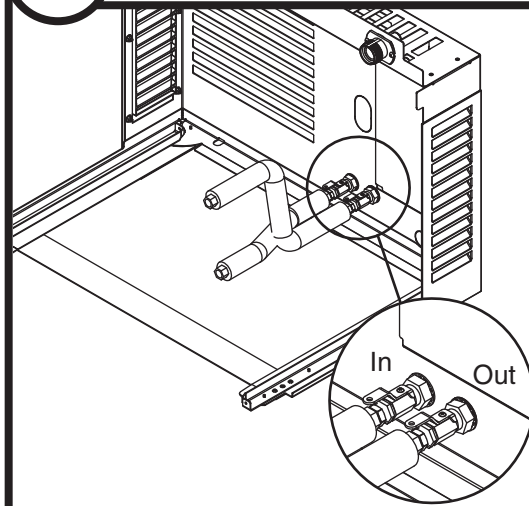

- Install ice machine cooling water lines to louvered docking assembly

7.7 Ice transport tube

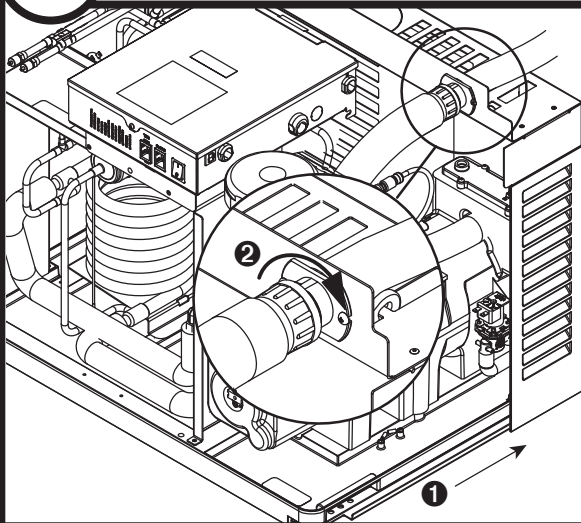

- Slide ice machine into louvered docking assembly ensuring that drain tube is fully seated on barbed drain fitting ①
- Insert ice transport tube into coupling and tighten nut firmly ②

7.8 Potable water and drain lines

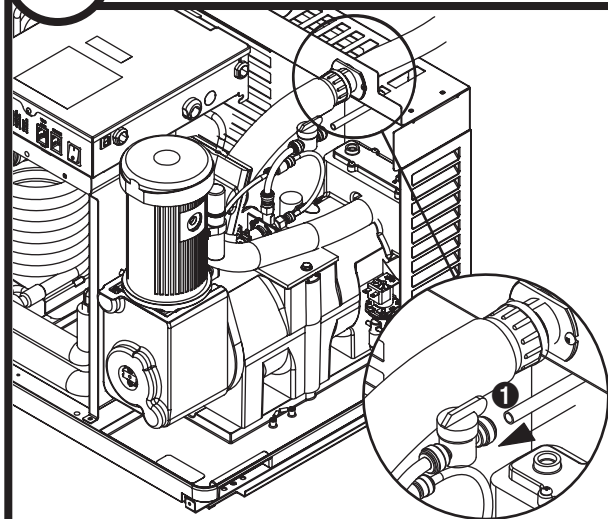

- Insert potable water line into valve ①

7.9 Cooling lines and power

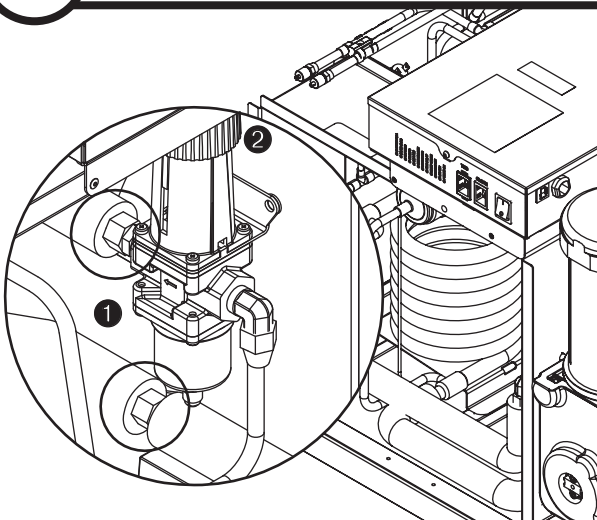

- Connect cooling water lines to ice machine (Water "Out" connects to water regulator.) ①
- Water valve is set at the factory. **DO NOT** remove seal or adjust water valve ②

7.10 Power cord

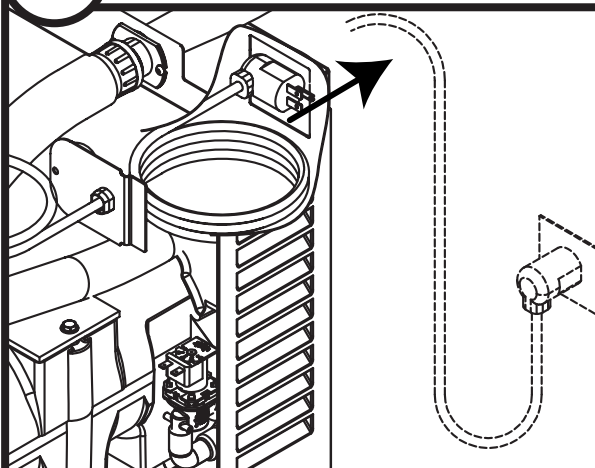

- Remove twist tie
- Carefully pass cord thru opening and plug into wall outlet
- For H_E units, install a suitable plug

7.11 Power cord

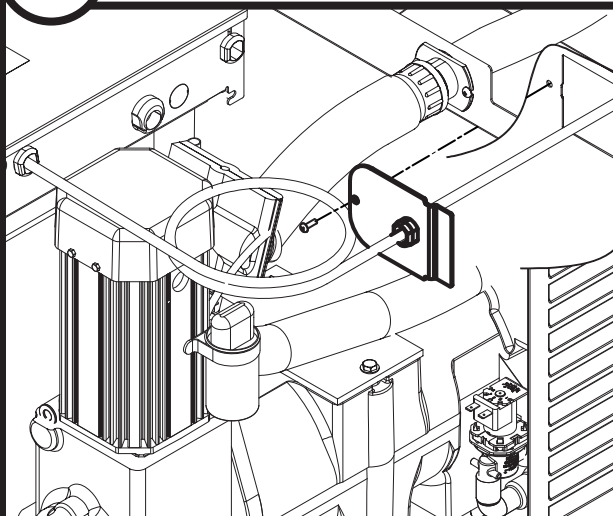

- Position plate into opening and secure with supplied screw

7.12 TDS switch

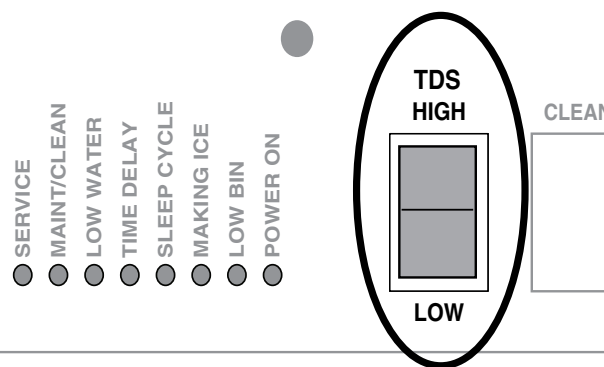

- Set the TDS switch on the electrical box:
HIGH: for extended service life
LOW: for low-scale water

Install front cover to ice machine.

Front cover

8

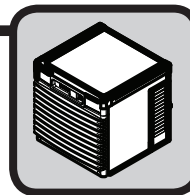

8.1 Install front cover

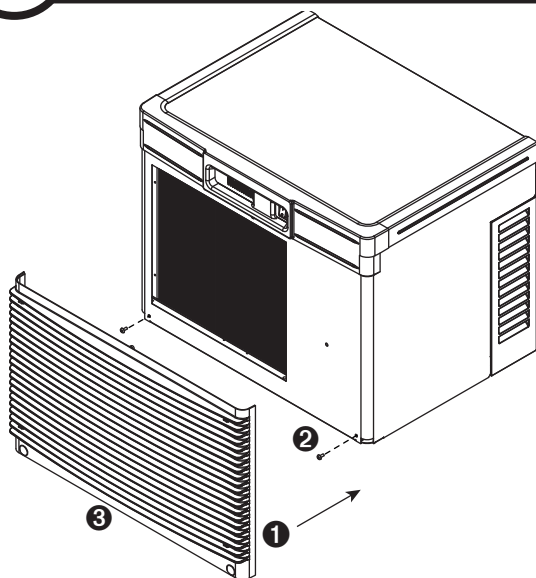

- Slide ice machine cover over machine ensuring that tabs on back of cover slip under louvers on back of louvered docking assembly ①
- Insert and tighten two screws through cover and into louvered docking assembly ②
- For air-cooled machines only, install plastic grill ③

NOTICE

Ice machine MUST be sanitized prior to operation!

Consult Operation and Service Manual provided with ice machine for sanitizing instructions.

Long tube run recommendations

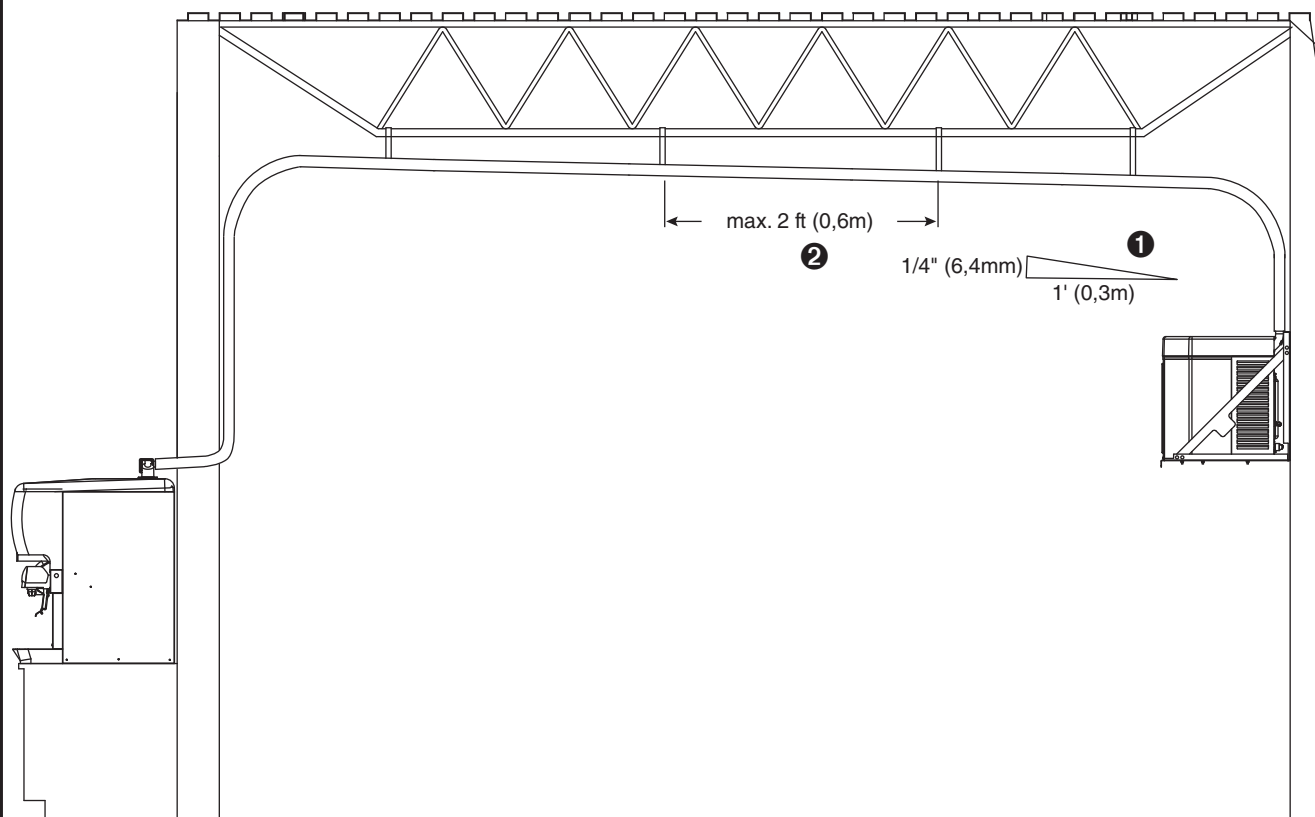

- Pitch ice transport tube to allow melt water to drain towards ice machine ①
- Secure insulated ice transport tube at least every 2 ft (0,6m) to prevent dips or traps ②

Horizon, Horizon Elite, Maestro, Harmony, Ice Manager, SafeCLEAN, Sani-Sponge and Vision are trademarks of Follett Corporation.
Chewblet, RIDE and Follett are registered trademarks of Follett Corporation, registered in the US.



801 Church Lane • Easton, PA 18040, USA
Toll free (877) 612-5086 • +1 (610) 252-7301
www.follettice.com



01113323R00
© Follett Corporation 4/16