

### Topic

A Time Delay Error where the ice maker's shuttle is triggered by a blockage of ice could be caused by a misalignment of Lane 1 and 2 in the Ice Manager Diverter Valve (IMDV). This happens when the linkage that switches Lane 1 and 2 is set to an incorrect length. The correct length between the linkages bolt heads is 4 1/4".

A slight misalignment between the two lanes can cause ice to jam inside the IMDV.



If you have any questions, please contact Follett Technical Support – (877) 612-5086 or [techsupport@follettice.com](mailto:techsupport@follettice.com).

### Action

Remove the inlet cover to the diverter valve and measure the center-to-center distance.

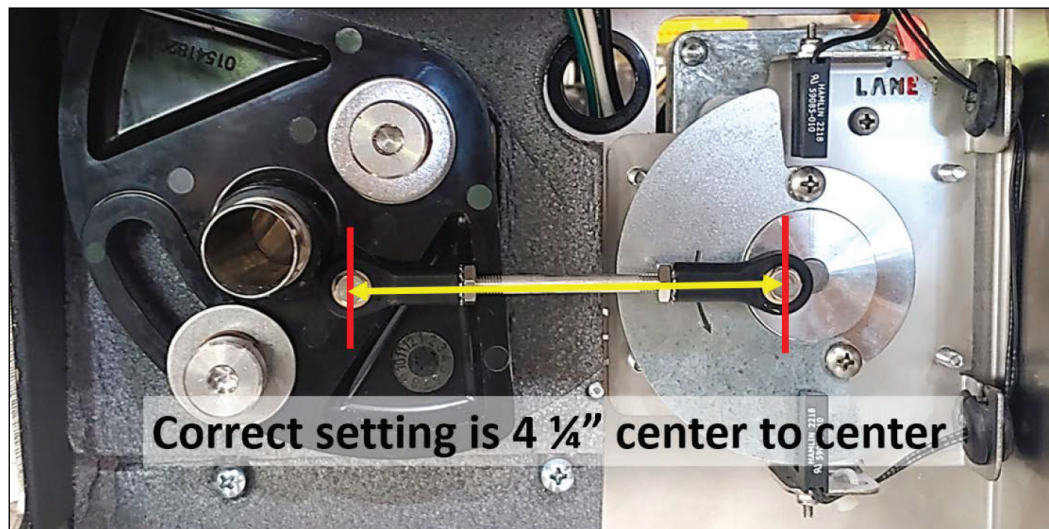

Ensure the two 5/16" bolts on the linkage are tight. Loose bolts can cause a misalignment.

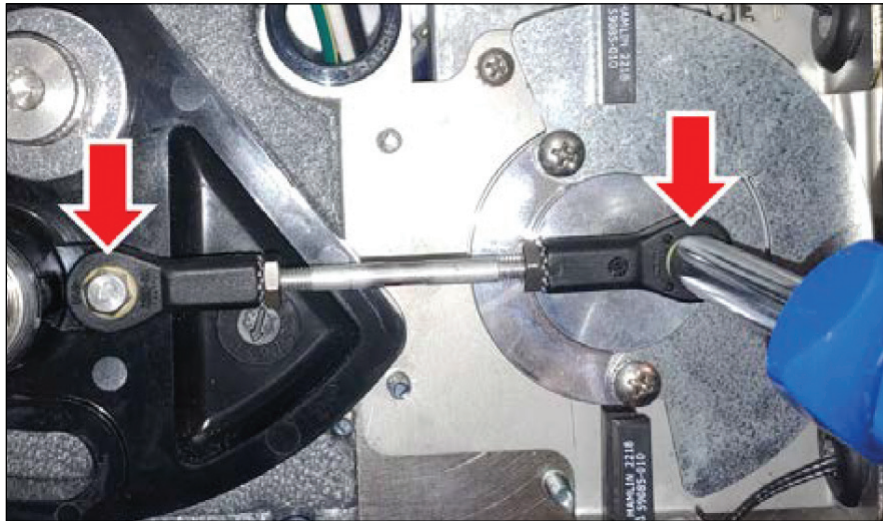

To adjust the length of the linkage, loosen the 3/8" jam nut on the connecting rod.



Remove the 5/16" bolt and the two 1/4" spacers from behind the connector. Be careful not to drop the spacers when pulling out the bolt.



Turn the rod ends to adjust the length between the bolt holes to 4.25" center to center.

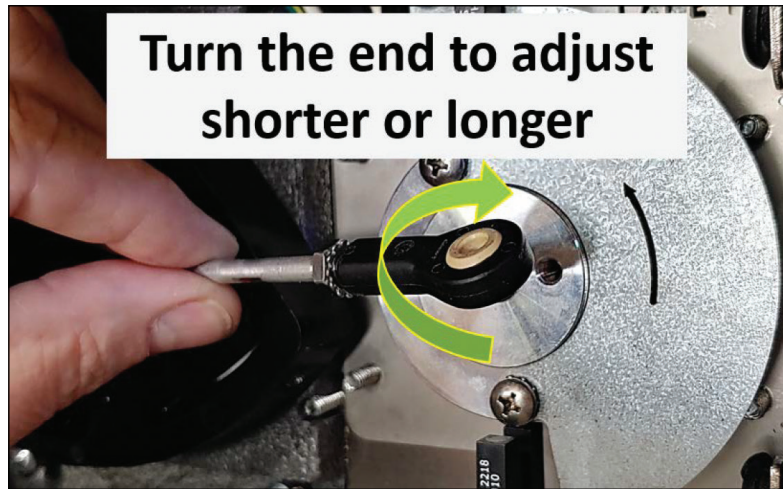

Reattach the control arm with the two spacers and tighten the bolt.

With the controller in Manual Mode, cycle between the two lanes a couple of times.

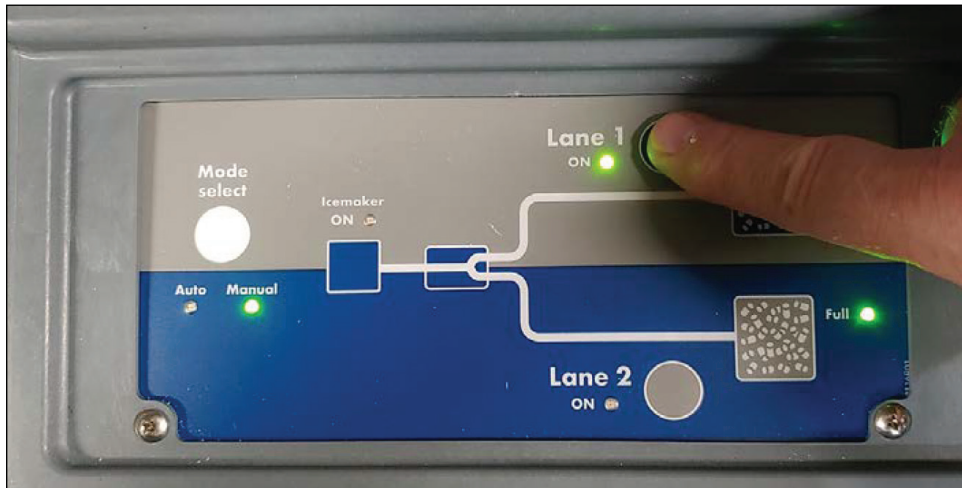

Look down both lanes to check alignment. A slight misalignment may be found, but it should be uniform between lane 1 and 2. A half turn adjustment of the rod end may be required to correct the spacing.

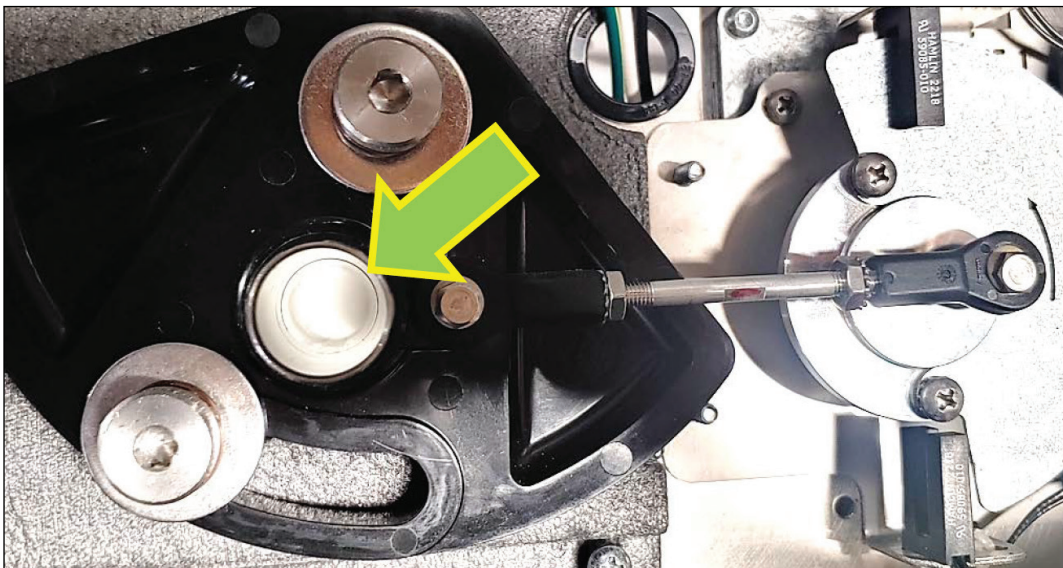

Follett is a registered trademark of Follett Products, LLC, registered in US.

---



801 Church Lane • Easton, PA 18040, USA  
(877) 612-5086 • +1 (610) 252-7301  
[www.follettice.com](http://www.follettice.com)

Follett Europe Polska Sp. z o.o.  
Mokry Dwór 26 c • 83-021 Wiślina, Poland  
[www.folletteurope.com](http://www.folletteurope.com)

TI TS TBE 013  
rev00  
11/24